

NOTICE!!

These documents have been scanned!

Do not place un-scanned documents beneath this notice!

Do not remove this notice from this file!

GPO Jacket No. 560-102
Print Order 61540
Rise Business Services, LLC
Job=AZ15 5/20/2019



Box Number= AZ15070



Claim Begin-End: AMC397901-AMC397908

1 Initial Receipt



AZ15070-12

AMC397273-AMC397967

United States Department of the Interior
Bureau of Land Management
 BUSINESS & SUPPORT SVCS DIV
 ONE N CENTRAL AVE SUITE 800
 PHOENIX, AZ 85004 -4427
 Phone: (602) 417-9200

Receipt

No:

2011531

Transaction #: 2076393		ENTERED INTO COMPUTER OCT 20 2009 <i>RB</i>
Date of Transaction: 10/06/2009		
CUSTOMER:	BANDNA MISRA 3937 TROPICAL VINE ST LAS VEGAS,NV 89147-8076 US	

LINE #	QTY	DESCRIPTION	REMARKS	UNIT PRICE	TOTAL
1	8.00	LOCATABLE MINERALS / MINING CLAIMS-NEW,UNADJUD, ONE OR MORE AUTH NOS / NEW MINING CLAIM LOCATION FEE \$34 CASES: AMC397901/\$34.00, AMC397902/\$34.00, AMC397903/\$34.00, AMC397904/\$34.00, AMC397905/\$34.00, AMC397906/\$34.00, AMC397907/\$34.00, AMC397908/\$34.00		- n/a -	272.00
2	8.00	LOCATABLE MINERALS / MINING CLAIMS-NEW,UNADJUD, ONE OR MORE AUTH NOS / NEW MINING CLAIM MAINT FEE \$140 CASES: AMC397901/\$140.00, AMC397902/\$140.00, AMC397903/\$140.00, AMC397904/\$140.00, AMC397905/\$140.00, AMC397906/\$140.00, AMC397907/\$140.00, AMC397908/\$140.00		- n/a -	1120.00
3	8.00	LOCATABLE MINERALS / MINING CLAIMS-NEW,UNADJUD, ONE OR MORE AUTH NOS / NEW MINING CLAIM PROCESSING FEE \$15 CASES: AMC397901/\$15.00, AMC397902/\$15.00, AMC397903/\$15.00, AMC397904/\$15.00, AMC397905/\$15.00, AMC397906/\$15.00, AMC397907/\$15.00, AMC397908/\$15.00		- n/a -	120.00
TOTAL:					\$1,512.00

PAYMENT INFORMATION			
1	AMOUNT:	1512.00	POSTMARKED: N/A
	TYPE:	CHECK	RECEIVED: 10/06/2009
	CHECK NO:	2325	
	NAME:	MISRA, BANDNA 3937 TROPICAL VINE ST LAS VEGAS NV 89147-8076 US	

REMARKS

This receipt was generated by the automated BLM Collections and Billing System and is a paper representation of a portion of the official electronic record contained therein.

NOTICE!!

These documents have been scanned!

Do not place un-scanned documents beneath this notice!

Do not remove this notice from this file!

GPO Jacket No. 560-102
Print Order 61540
Rise Business Services, LLC
Job=AZ15 5/20/2019



Box Number= AZ15070



Claim Begin-End: AMC397901-AMC397908

2 Correspondence



AZ15070-12

AMC397273-AMC397967

7/8/10
ATC
7/08/10
S. J. Jansen

JUL 08 2010

In Reply Refer To:
3800 (9310) AT
AMC397901, AMC397893

CERTIFIED MAIL - RETURN RECEIPT REQUESTED No. 7010 0780 0001 4667 9257

DECISION

Misra Bandna; Neha Gupta	:	AMC397905 – 397908,
Humanitarian Foundation	:	AMC397897 - 397900
3937 Tropical Vine Street	:	JAS-5 thru JAS-8,
Las Vegas, Nevada 89147-8076	:	MANJ-5 thru MANJ-8

Mining Claims Declared Null and Void Ab Initio

Pursuant to Title 43 Code of Federal Regulations (CFR) 3832.1, this office received your notices of location for recordation of mining claims. An insufficient amount of money was received with the claims. Therefore, the claims listed above are declared null and void ab initio.

The location dates on the claims are prior to September 1, 2009, which means they were located in the 2009 assessment year. Therefore, in accordance with 43 CFR 3830.21, \$170 per claim was due at the time of recording (\$15 service fee, \$30 location fee, and \$125 maintenance fee for the 2009 assessment year). However, because you did not record the claims until after September 1, 2009, the 2010 assessment year fee of \$140 was also due at the time of recordation (a total of \$310 per claim). In accordance with 43 CFR 3830.25 and 3830.91, the fees must be paid in full at the time you record a new mining claim, or the claim will be forfeited. Therefore, after subtracting the \$15 per claim non-refundable processing fee for each claim, the remaining funds were applied to as many claims as possible, and those claims are in good standing. However, there was not enough money to pay the fees for the claims listed above. Therefore, the claims listed above are declared null and void and will be closed. A refund will be issued for any remaining money.

This decision may be appealed to the Interior Board of Land Appeals, Office of the Secretary, in accordance with the regulations contained in 43 CFR, Part 4, and the enclosed Form 1842-1. If an appeal is taken, your notice of appeal must be filed in this office (at the above address) within

30 days from receipt of this decision. The appellant has the burden of showing that the decision appealed from is in error.

If you wish to file a petition pursuant to regulation 43 CFR 4.21 (58 FR 4939, January 19, 1993), for a stay of the effectiveness of this decision during the time that your appeal is being reviewed by the Board, the petition for a stay must accompany your notice of appeal. A petition for a stay is required to show sufficient justification based on the standards listed below. Copies of the notice of appeal and petition for a stay must also be submitted to each party named in this decision and to the Interior Board of Land Appeals and to the appropriate Office of the Solicitor (see 43 CFR 4.413) at the same time the original documents are filed with this office. If you request a stay, you have the burden of proof to demonstrate that a stay should be granted.

Standards for Obtaining a Stay

Except as otherwise provided by law or other pertinent regulation, a petition for a stay of a decision pending appeal shall show sufficient justification based on the following standards:

- (1) The relative harm to the parties if the stay is granted or denied,
- (2) The likelihood of the appellant's success on the merits,
- (3) The likelihood of immediate and irreparable harm if the stay is not granted, and
- (4) Whether the public interest favors granting the stay.

If additional information is required, please contact Amy Thrower at 602-417-9334. Please include your AMC serial number(s) on all correspondence.

Stephen K. Hansen
Acting Group Administrator
Renewable and Mineral Resources

Enclosure

AThrower:met:7/7/10



Home | Help | Contact Us

Track & Confirm 800

Track & Confirm

Track & Confirm

Label/Receipt Number: **7010 0780 0001 4667 9257**
Service(s): **Certified Mail™**
Status: **Delivered**

Enter Label/Receipt Number.

Your item was delivered at 10:20 am on July 16, 2010 in LAS VEGAS, NV 89147.

Detailed Results:

- **Delivered, July 16, 2010, 10:20 am, LAS VEGAS, NV 89147**
- **Notice Left, July 10, 2010, 9:32 am, LAS VEGAS, NV 89147**

Track & Confirm by email

Get current event information or updates for your item sent to you or others by email.

Event	Event Date	Event Time	Event Location	Event Status	Event Type	Event Description
Notice Left	July 10, 2010	9:32 am	LAS VEGAS, NV 89147	Completed	Notice Left	Notice Left
Delivered	July 16, 2010	10:20 am	LAS VEGAS, NV 89147	Completed	Delivered	Delivered



NOTICE!!

These documents have been scanned!

Do not place un-scanned documents beneath this notice!

Do not remove this notice from this file!

GPO Jacket No. 560-102
Print Order 61540
Rise Business Services, LLC
Job=AZ15 5/20/2019



Box Number= AZ15070



Claim Begin-End: AMC397901-AMC397908

3 Transfers



AZ15070-12

AMC397273-AMC397967

**NO
DOCUMENTS
FOUND**

NO DOCUMENTS FOUND
NO DOCUMENTS FOUND

NOTICE!!

These documents have been scanned!

Do not place un-scanned documents beneath this notice!

Do not remove this notice from this file!

GPO Jacket No. 560-102
Print Order 61540
Rise Business Services, LLC
Job=AZ15 5/20/2019



Box Number= AZ15070



Claim Begin-End: AMC397901-AMC397908

4 Annual Filings



AZ15070-12

AMC397273-AMC397967

397893

397901

August 17, 2018

Bandna Misra
3937 Tropical Vine St
Las Vegas, Nevada 89147
Phone: (702) 460-4050

Arizona State Office
One North Central Avenue
Suite 800
Phoenix, AZ 85004-4427
Phone: (602) 417-9200

RECEIVED
BLM ARIZONA STATE OFFICE
2018 AUG 21 P 1:29
PHOENIX, ARIZONA

BLM Annual Filing Dept.,

I am paying the annual maintenance fees for the eight Mineral Claims in Mohave County, Arizona. This payment covers the period September 1, 2018 to September 1, 2019.

Claim names: Manj 1, Manj 2, Manj 3, Manj 4
Meridian 14, Township 15N, Range 13 W, Section 8, NW/SW subdivision.
AMC397893; AMC397894; AMC397895; AMC397896

Claim names: Jas 1-4, Jas 2, Jas 3, Jas 4
Meridian 14, Township 15N, Range 13W, Section 8, NW subdivision.
AMC397901; AMC397902; AMC397903; AMC397904

Total fees for these Eight Claims are $\$155 \times 8 = \$1,240$

I am also enclosing my confidential credit card number authorizing BLM Arizona to charge my ~~credit card~~ for \$1,240.00 only.

~~Credit Card:~~ _____ Check # 1091

4243487

ENTERED
AUG 28 2018
BY: RAm

Bandna Misra
3937 Tropical vine st
Lv NV 89147

145 VEGAS NV 89100

17 AUG 2018 PM 4 L



BLM
Arizona state office
One North Central Avenue
Suite 800
Phoenix, AZ 85004-4427

PHOENIX, ARIZONA

2018 AUG 21 P 1:29

RECEIVED
BLM AZ STATE OFFICE

85004-442700

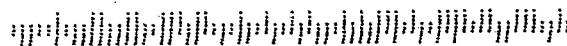

United States Department of the Interior
Bureau of Land Management
 DIV OF LANDS, MINRLS & ENERGY
 ONE N CENTRAL AVE
 PHOENIX, AZ 85004 -4427
 Phone: 602-417-9200

Receipt

No: 4243487

Transaction #: 4358925	
Date of Transaction: 08/24/2018	
CUSTOMER:	
DEEPAK SHARMA 3937 TROPICAL VINE ST LAS VEGAS,NV 89147-8076 US	

LINE #	QTY	DESCRIPTION	REMARKS	UNIT PRICE	TOTAL
1	1.00	LOCATABLE MINERALS / MINING CLAIMS- NOT NEW-UNADJUD,ONE AUTH NO. ONLY / MINING CLAIM MONEY RECEIVED CASES: AMC397893/\$1240.00	MAINT 2019/8	- n/a -	1240.00
TOTAL:					\$1,240.00

PAYMENT INFORMATION			
1	AMOUNT:	1240.00	POSTMARKED: N/A
	TYPE:	CHECK	RECEIVED: 08/21/2018
	CHECK NO:	1091	
	NAME:	SHARMA, DEEPAK 3937 TROPICAL VINE ST LAS VEGAS NV 89147-8076 US	

REMARKS

This receipt was generated by the automated BLM Collections and Billing System and is a paper representation of a portion of the official electronic record contained therein.

397893

397901

August 17, 2017

Bandna Misra
3937 Tropical Vine St
Las Vegas, Nevada 89147
Phone: (702) 460-4050

Arizona State Office
One North Central Avenue
Suite 800
Phoenix, AZ 85004-4427
Phone:(602) 417-9200

PHOENIX, ARIZONA

2017 AUG 18 P 3:18

RECEIVED
BLM AZ STATE OFFICE

BLM Annual Filing Dept.,

I am paying the annual maintenance fees for the eight Mineral Claims in Mohave County, Arizona. This payment covers the period September 1, 2016 to September 1, 2018

Claim names: Manj 1, Manj 2, Manj 3, Manj 4
Meridian 14, Township 15N, Range 13 W, Section 8, NW/SW subdivision.
AMC397893; AMC397894; AMC397895; AMC397896

Claim names: Jas 1, Jas 2, Jas 3, Jas 4
Meridian 14, Township 15N, Range 13W, Section 8, NW subdivision.
AMC397901; AMC397902; AMC397903; AMC397904

Total fees for these Eight Claims are $\$155 \times 8 = \$1,240$

I am also enclosing my confidential credit card number authorizing BLM Arizona to charge my credit card for \$1,240.00 only.

Credit Card: check # 1012 Dated 08/15/17

INTERE
AUG 24 2017
BY: *Ram*

3947394

United States Department of the Interior
Bureau of Land Management
 DIV OF LANDS, MINRLS & ENERGY
 ONE N CENTRAL AVE
 PHOENIX, AZ 85004 -4427
 Phone: 602-417-9200

Receipt

No: 3947394

Transaction #: 4057104	
Date of Transaction: 08/21/2017	
CUSTOMER:	
BANDNA MISRA 3937 TROPICAL VINE ST LAS VEGAS,NV 89147-8076 US	

LINE #	QTY	DESCRIPTION	REMARKS	UNIT PRICE	TOTAL
1	1.00	LOCATABLE MINERALS / MINING CLAIMS- NOT NEW-UNADJUD, ONE AUTH NO. ONLY / MINING CLAIM MONEY RECEIVED CASES: AMC397893/\$1240.00	MAINT 2018/8	- n/a -	1240.00
TOTAL:					\$1,240.00

PAYMENT INFORMATION					
1	AMOUNT:	1240.00	POSTMARKED:	08/16/2017	
	TYPE:	CHECK	RECEIVED:	08/18/2017	
	CHECK NO:	1012			
	NAME:	DEEPAK SHARMA MD LTD 3937 TROPICAL VINE ST LAS VEGAS NV 89147-8076 US			

REMARKS

This receipt was generated by the automated BLM Collections and Billing System and is a paper representation of a portion of the official electronic record contained therein.

AMC 397893

AMC 397901

RECORDED REQUESTED BY:
Bandna Misra of 3937 Tropical Vine St.
Las Vegas, Nevada 89147

**WHEN RECORDED MAIL THIS
DEED AND TAX STATEMENTS TO:**
Bandna Misra of 3937 Tropical Vine St.
Las Vegas, Nevada 89147

2017 APR 17 P 11:11 AM
REC'D BY: [illegible]

GRANT BARGAIN and SALE DEED

THIS INDENTURE WITNESSETH: That on the 7th day of October, 2016
Neha Gupta, sole Trustee of Neha Gupta Humanitarian Foundation
Trust, located at 1234 12th Street, #2, Santa Monica, California, USA
90401, hereinafter called "Grantor",

for and in consideration of the sum of Ten Dollars (\$10) and other valu-
able considerations which is hereby acknowledged, paid by the party
of the second part, does hereby grant, release, and forever quitclaim
unto the Grantee,

**Bandna Misra of 3937 Tropical Vine Street, Las Vegas, Nevada 89147
hereinafter called "Grantee"**

her entire vested interest in the following Bureau of Land Management
eight mineral claims:

**Claim names: Manj 1, Manj 2, Manj 3, Manj 4
Meridian 14, Township 15N, Range 13 W, Section 8, NW/SW subdivision.
AMC397893; AMC397894; AMC397895; AMC397896**

**Claim names: Jas 1-4, Jas 2, Jas 3, Jas 4
Meridian 14, Township 15N, Range 13W, Section 8, NW subdivision.
AMC397901; AMC397902; AMC397903; AMC397904**First Lot:

ENTERED
APR 26 2017
BY: RWS

See AMC 397893
for clearer date stamp

This Grant Bargain and Sale Deed was signed by Neha Gupta, sole Trustee of the Neha Gupta Humanitarian Foundation Trust in front of a Public Notary

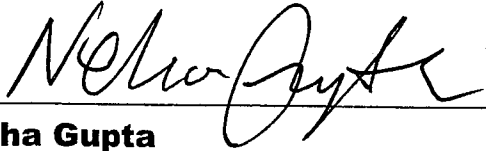

Neha Gupta

PUBLIC NOTARY *see attachment Ch*

PHOENIX, ARIZONA
2011 APR 17 P 3:38

CALIFORNIA ALL-PURPOSE CERTIFICATE OF ACKNOWLEDGMENT

A notary public or other officer completing this certificate verifies only the identity of the individual who signed the document to which this certificate is attached, and not the truthfulness, accuracy, or validity of that document.

State of California

County of Los Angeles

On Oct 11, 2014 before me, Diana Garcia, Notary Public,
(Here insert name and title of the officer)

personally appeared Neha Gupta,

who proved to me on the basis of satisfactory evidence to be the person(s) whose name(s) is/are subscribed to the within instrument and acknowledged to me that he/she/they executed the same in his/her/their authorized capacity(ies), and that by his/her/their signature(s) on the instrument the person(s), or the entity upon behalf of which the person(s) acted, executed the instrument.

I certify under PENALTY OF PERJURY under the laws of the State of California that the foregoing paragraph is true and correct.

WITNESS my hand and official seal.

Diana Garcia
Signature of Notary Public

(Notary Seal)

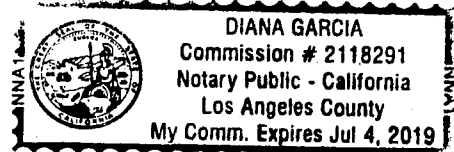

ADDITIONAL OPTIONAL INFORMATION

DESCRIPTION OF THE ATTACHED DOCUMENT

Grant Bargain and
(Title or description of attached document)

Sale Deed
(Title or description of attached document continued)

Number of Pages 2 Document Date 10/11/14

(Additional information)

CAPACITY CLAIMED BY THE SIGNER

- Individual (s)
 Corporate Officer

(Title)

- Partner(s)
 Attorney-in-Fact
 Trustee(s)
 Other _____

INSTRUCTIONS FOR COMPLETING THIS FORM

Any acknowledgment completed in California must contain verbiage exactly as appears above in the notary section or a separate acknowledgment form must be properly completed and attached to that document. The only exception is if a document is to be recorded outside of California. In such instances, any alternative acknowledgment verbiage as may be printed on such a document so long as the verbiage does not require the notary to do something that is illegal for a notary in California (i.e. certifying the authorized capacity of the signer). Please check the document carefully for proper notarial wording and attach this form if required.

- State and County information must be the State and County where the document signer(s) personally appeared before the notary public for acknowledgment.
- Date of notarization must be the date that the signer(s) personally appeared which must also be the same date the acknowledgment is completed.
- The notary public must print his or her name as it appears within his or her commission followed by a comma and then your title (notary public).
- Print the name(s) of document signer(s) who personally appear at the time of notarization.
- Indicate the correct singular or plural forms by ~~crossing off~~ crossing off incorrect forms (i.e. ~~he/she/they~~ is/are) or circling the correct forms. Failure to correctly indicate this information may lead to rejection of document recording.
- The notary seal impression must be clear and photographically reproducible. Impression must not cover text or lines. If seal impression smudges, re-seal if a sufficient area permits, otherwise complete a different acknowledgment form.
- Signature of the notary public must match the signature on file with the office of the county clerk.
 - ❖ Additional information is not required but could help to ensure this acknowledgment is not misused or attached to a different document.
 - ❖ Indicate title or type of attached document, number of pages and date.
 - ❖ Indicate the capacity claimed by the signer. If the claimed capacity is a corporate officer, indicate the title (i.e. CEO, CFO, Secretary).
- Securely attach this document to the signed document

United States Department of the Interior
Bureau of Land Management
 DIV OF LANDS, MINRLS & ENERGY
 ONE N CENTRAL AVE
 PHOENIX, AZ 85004 -4427
 Phone: 602-417-9200

Receipt

No: 3811966

Transaction #: 3919792	
Date of Transaction: 04/18/2017	
CUSTOMER:	
DEEPAK SHARMA 3937 TROPICAL VINE ST LAS VEGAS,NV 89147-8076 US	

LINE #	QTY	DESCRIPTION	REMARKS	UNIT PRICE	TOTAL
1	1.00	LOCATABLE MINERALS / MINING CLAIMS- NOT NEW-UNADJUD,ONE AUTH NO. ONLY / MINING CLAIM MONEY RECEIVED CASES: AMC397893/\$80.00	TRF/8	- n/a -	80.00
TOTAL:					\$80.00

PAYMENT INFORMATION					
1	AMOUNT:	80.00	POSTMARKED:	04/12/2017	
	TYPE:	CHECK	RECEIVED:	04/17/2017	
	CHECK NO:	1272			
	NAME:	MISRA, BANDNA 3937 TROPICAL VINE ST LAS VEGAS NV 89147-8076 US			

REMARKS

This receipt was generated by the automated BLM Collections and Billing System and is a paper representation of a portion of the official electronic record contained therein.

April 4, 2017

Bandna Misra
3937 Tropical vine st
Las Vegas, NV 89147

BLM Arizona
1 N. Central Avenue
Suite 800
Phoenix, AZ 85004

RECEIVED
2017 APR 17 P 3:37
PHOENIX, ARIZONA

BLM Arizona transfer deed dept.

I am sending \$80.00 check. please record the transfer deed.

Thank you.
~~Bandna~~ Misra

B811966

397893

397901

August 17, 2016

Bandna Misra
3937 Tropical Vine St
Las Vegas, Nevada 89147
Phone: (702) 460-4050

RECEIVED
BLM AZ STATE OFFICE

2016 AUG 12 P 2:53

PHOENIX, ARIZONA

Arizona State Office
One North Central Avenue
Suite 800
Phoenix, AZ 85004-4427
Phone:(602) 417-9200

BLM Annual Filing Dept.,

I am paying the annual maintenance fees for the eight Mineral Claims in Mohave County, Arizona. This payment covers the period September 1, 2016 to September 1, 2017.

Claim names: Manj 1, Manj 2, Manj 3, Manj 4
Meridian 14, Township 15N, Range 13 W, Section 8, NW/SW subdivision.
AMC397893; AMC397894; AMC397895; AMC397896

Claim names: Jas 1-4, Jas 2, Jas 3, Jas 4
Meridian 14, Township 15N, Range 13W, Section 8, NW subdivision.
AMC397901; AMC397902; AMC397903; AMC397904

Total fees for these Eight Claims are $\$155 \times 8 = \$1,240$

I am also enclosing my confidential credit card number authorizing BLM Arizona to charge my credit card for \$1,240.00 only.

~~Credit Card:~~ Check Number # 2703

Amount \$1240.00

Date 08/02/2016

INTERED
AUG 17 2016
BY: Rpm

3630260

Bandna Misra.
3937 Tropical Vine St
Las Vegas, NV 89147

LAS VEGAS NV 890

09 AUG 2016 PM 4 L

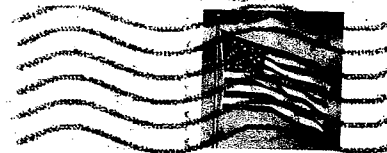

USA FOREVER

BLM Arizona
Arizona state office
One North Central Avenue
Suite 800
Phoenix, AZ 85004-4427

PHOENIX, ARIZONA

2016 AUG 12 P 2:53

RECEIVED
BLM AZ STATE OFFICE

8500484427 0041

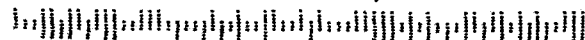

Bandna Misra.
3937 Tropical Vine St
Las Vegas, NV 89147

LAS VEGAS NV 890

09 AUG 2016 FRI 4 L



PHOENIX, ARIZONA

2016 AUG 12 P 2:53

RECEIVED
BLM AZ STATE OFFICE

BLM Arizona
Arizona state office
One North Central Avenue
Suite 800
Phoenix, AZ 85004-4427

8500484427 0041



United States Department of the Interior
Bureau of Land Management
 DIV OF LANDS, MINRLS & ENERGY
 ONE N CENTRAL AVE
 PHOENIX, AZ 85004 -4427
 Phone: 602-417-9200

Receipt

No: 3630260

Transaction #: 3734048	
Date of Transaction: 08/15/2016	
CUSTOMER:	
BANDNA MISRA 3937 TROPICAL VINE ST LAS VEGAS,NV 89147-8076 US	

LINE #	QTY	DESCRIPTION	REMARKS	UNIT PRICE	TOTAL
1	1.00	LOCATABLE MINERALS / MINING CLAIMS- NOT NEW-UNADJUD,ONE AUTH NO. ONLY / MINING CLAIM MONEY RECEIVED CASES: AMC397893/\$1240.00	MAINT 2017/8	- n/a -	1240.00
TOTAL:					\$1,240.00

PAYMENT INFORMATION					
1	AMOUNT:	1240.00	POSTMARKED:	08/09/2016	
	TYPE:	CHECK	RECEIVED:	08/12/2016	
	CHECK NO:	2703			
	NAME:	MISRA, BANDNA 3937 TROPICAL VINE ST LAS VEGAS NV 89147-8076 US			

REMARKS	

This receipt was generated by the automated BLM Collections and Billing System and is a paper representation of a portion of the official electronic record contained therein.

397893

397901

August 17, 2015

Bandna Misra
3937 Tropical Vine St
Las Vegas, Nevada 89147
Phone: (702) 460-4050

Arizona State Office
One North Central Avenue
Suite 800
Phoenix, AZ 85004-4427
Phone:(602) 417-9200

RECEIPT # 3377601

BLM Annual Filing Dept.,

I am paying the annual maintenance fees for the eight Mineral Claims in Mohave County, Arizona. This payment covers the period September 1, 2015 to September 1, 2016.

Claim names: Manj 1, Manj 2, Manj 3, Manj 4
Meridian 14, Township 15N, Range 13 W, Section 8, NW/SW subdivision.
AMC397893; AMC397894; AMC397895; AMC397896

Claim names: Jas 1-4, Jas 2, Jas 3, Jas 4
Meridian 14, Township 15N, Range 13W, Section 8, NW subdivision.
AMC397901; AMC397902; AMC397903; AMC397904

Total fees for these Eight Claims are \$155 X 8 = \$1,240

I am also enclosing my confidential credit card number authorizing BLM Arizona to charge mv credit card for \$1,240.00 only.

Credit Card: _____

Authorized Signature

ENTERED
AUG 23 2015
BY: RE

RECEIVED
BLM ARIZONA OFFICE
2015 AUG 25 P 2:46
PHOENIX, ARIZONA

Bandna Misra
3937 Tropical vine st
Las Vegas, Nevada 89147

LAS VEGAS NV 890

18 AUG 2015 PM 4 L

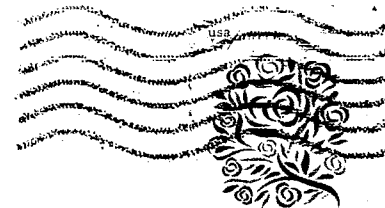

RECEIVED
BLM AZ STATE OFFICE

2015 AUG 25 P 2:05

PHOENIX, ARIZONA

Arizona State office
One North central Avenue
Suite 800
Phoenix, AZ 85004-4427

85004442700

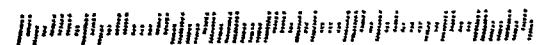

United States Department of the Interior
Bureau of Land Management
LANDS/RECREATION & PLANNING
ONE N CENTRAL AVE
PHOENIX, AZ 85004 -2203
Phone: 602-417-9200

Receipt

No: 3377601

Transaction #: 3475849	
Date of Transaction: 08/26/2015	
CUSTOMER:	
BANDNA MISRA 3937 TROPICAL VINE ST LAS VEGAS, NV 89147-8076 US	

LINE #	QTY	DESCRIPTION	REMARKS	UNIT PRICE	TOTAL
1	1.00	LOCATABLE MINERALS / MINING CLAIMS- NOT NEW-UNADJUD, ONE AUTH NO. ONLY / MINING CLAIM MONEY RECEIVED CASES: AMC397893/\$1240.00	MAINT FEE PYMNT - 8 2016	- n/a -	1240.00
TOTAL:					\$1,240.00

PAYMENT INFORMATION			
NOTE: Items will appear on credit card statement as "Bureau of Land Mgmt CO".			
1	AMOUNT:	1240.00	POSTMARKED: N/A
	TYPE:	CREDIT CARD	RECEIVED: 08/22/2015
	NAME:	MISRA, BANDNA 3937 TROPICAL VINE ST LAS VEGAS NV 89147-8076 US	
	CARD NO:	XXXXXXXXXXXX6958	AUTH CODE: 026997
	NAME ON CARD:	BANDNA MISRA	
	EXPIRES:	11/2017	
	SIGNATURE:		

REMARKS

This receipt was generated by the automated BLM Collections and Billing System and is a paper representation of a portion of the official electronic record contained therein.

Run Date: 08/20/14

26

Run Time: 03:40 PM

397893

397901

**DEPARTMENT OF THE INTERIOR
BUREAU OF LAND MANAGEMENT
MINING CLAIMS**

MC Maintenance Fees Paid Through the BLM Pay Portal

CBS Receipt: 3103170

Agency Tracking ID: 9454632

Assessment Year: 2015

Paid On : 08/15/2014

Number of BLM Serial Nr: 8

Total Amount Paid: \$1,240.00

Claim Name	BLM Serial No	Lead File No	Case Type	Amount Paid
MANJ-1	AMC397893	AMC397893	384101	\$155.00
MANJ-2	AMC397894			\$155.00
MANJ-3	AMC397895			\$155.00
MANJ-4	AMC397896			\$155.00
JAS-1	AMC397901	AMC397901		\$155.00
JAS-2	AMC397902			\$155.00
JAS-3	AMC397903			\$155.00
JAS-4	AMC397904			\$155.00

United States Department of the Interior
Bureau of Land Management
 BUSINESS & SUPPORT SVCS DIV
 ONE N CENTRAL AVE SUITE 800
 PHOENIX, AZ 85004 -4427
 Phone: (602) 417-9200

Receipt

No: 3103170

Transaction #: 3194752	
Date of Transaction: 08/15/2014	
CUSTOMER:	
	BANDNA MISRA 3937 TROPICAL VINE STREET LAS VEGAS,NV 89147

LINE #	QTY	DESCRIPTION	REMARKS	UNIT PRICE	TOTAL
1	1.00	LOCATABLE MINERALS / MINING CLAIMS- NOT NEW-UNADJUD,ONE AUTH NO. ONLY / MINING CLAIM MONEY RECEIVED CASES: AMC397903/\$1240.00		- n/a -	1240.00
TOTAL:					\$1,240.00

PAYMENT INFORMATION			
NOTE: Items will appear on credit card statement as "BLM O Mining Claim".			
1	AMOUNT:	1240.00	POSTMARKED: N/A
	TYPE:	CREDIT CARD	RECEIVED: 08/15/2014
	NAME:	BANDNA MISRA 3937 TROPICAL VINE STREET LAS VEGAS NV 89147	
	CARD NO:	XXXXXXXXXXXX6958	AUTH CODE: 015668
	NAME ON CARD:	BANDNA MISRA	
	EXPIRES:	01/2017	
	SIGNATURE:		

REMARKS

This receipt was generated by the automated BLM Collections and Billing System and is a paper representation of a portion of the official electronic record contained therein.

377893

397901

July 14, 2013

Bandna Misra
3937 Tropical Vine St
Las Vegas, Nevada 89147
Phone: (702) 460-4050

Arizona State Office
One North Central Avenue
Suite 800
Phoenix, AZ 85004-4427
Phone:(602) 417-9200

RECEIVED
BLM AZ STATE OFFICE
PHOENIX, ARIZONA
2013 AUG 15 PM 2:48

BLM Annual Filing Dept.,

I am paying the annual maintenance fees for the eight Mineral Claims in Mohave County, Arizona. This payment covers the period September 1, 2013 to September 1, 2014.

Claim names: Manj 1, Manj 2, Manj 3, Manj 4
Meridian 14, Township 15N, Range 13 W, Section 8, NW/SW subdivision.
AMC397893; AMC397894; AMC397895; AMC397896

Claim names: Jas 1-4, Jas 2, Jas 3, Jas 4
Meridian 14, Township 15N, Range 13W, Section 8, NW subdivision.
AMC397901; AMC397902; AMC397903; AMC397904

Total fees for these Eight Claims are $\$140 \times 8 = \$1,120.00$

I am also enclosing my confidential credit card number authorizing BLM Arizona to charge my credit card for \$1,120.00 (One thousand one hundred twenty dollars) only.

Credit Card (visa)

Information: _____

Signed by authorized party: Bandna Misra Bandna Misra

ENTERED IN COMPUTER
RE 8-23-13

United States Department of the Interior

Bureau of Land Management

LANDS/RECREATION & PLANNING

ONE N CENTRAL AVE

PHOENIX, AZ 85004 -2203

Phone: 602-417-9200

Receipt

No:

2857514

Transaction #: 2943335	
Date of Transaction: 08/16/2013	
CUSTOMER:	
BANDNA MISRA 3937 TROPICAL VINE ST LAS VEGAS,NV 89147-8076 US	

LINE #	QTY	DESCRIPTION	REMARKS	UNIT PRICE	TOTAL
1	1.00	LOCATABLE MINERALS / MINING CLAIMS-NOT NEW-UNADJUD,ONE AUTH NO. ONLY / MINING CLAIM MONEY RECEIVED CASES: AMC397893/\$1120.00	Maint 2014/8	- n/a -	1120.00
TOTAL:					\$1,120.00

PAYMENT INFORMATION				
NOTE: Items will appear on credit card statement as "Bureau of Land Mgmt CO".				
1	AMOUNT:	1120.00	POSTMARKED:	N/A
	TYPE:	CREDIT CARD	RECEIVED:	08/16/2013
	NAME:	MISRA, BANDNA 3937 TROPICAL VINE ST LAS VEGAS NV 89147-8076 US		
	CARD NO:	XXXXXXXXXXXX4700	AUTH CODE:	016184
	NAME ON CARD:	BANDNA MISRA		
	EXPIRES:	08/2016		
	SIGNATURE:			

REMARKS

This receipt was generated by the automated BLM Collections and Billing System and is a paper representation of a portion of the official electronic record contained therein.

AMC 397893

AMC 397901

August 24, 2012

BandnaMisra
3937 Tropical Vine St
Las Vegas, Nevada 89147
Phone: (702) 460-4050

Arizona State Office
One North Central Avenue
Suite 800
Phoenix, AZ 85004-4427
Phone: (602) 417-9200

NO. OF CLAIMS 8
AMOUNT \$1120.00
RECEIPT NO. 21051944
INIT. AMH

** BLM-ASO**

TIMELY FILED
PHOENIX, ARIZONA

RECEIVED
BLM AZ STATE OFFICE
2012 SEP -5 P 1:33

BLM Annual Filing Dept.,

I am paying the annual maintenance fees for the eight Mineral Claims in Mohave County, Arizona. This payment covers the period September 1, 2012 to September 1, 2013.

Claim names: Manj 1, Manj 2, Manj 3, Manj 4
Meridian 14, Township 15N, Range 13 W, Section 8, NW/SW subdivision.
AMC397893; AMC397894; AMC397895; AMC397896

Claim names: Jas 1-4, Jas 2, Jas 3, Jas 4
Meridian 14, Township 15N, Range 13W, Section 8, NW subdivision.
AMC397901; AMC397902; AMC397903; AMC397904

Total fees for these Eight Claims are $\$140 \times 8 = \$1,120.00$

I am also enclosing my confidential credit card number authorizing BLM Arizona to charge my credit card for \$1,120.00 (One thousand one hundred twenty dollars) only.

Credit Card

Information: _____

Telephone # (702) 460-4050

Signed by authorized party: Bandna Misra BandnaMisra

9/12/2012

ENTERED INTO COMPUT

Bandna Misra
3937 Tropical vine st
Las Vegas, NV 89147

TIMELY FILED

RECEIVED
BLM AZ STATE OFFICE

2012 SEP -5 P 1:33

PHOENIX, ARIZONA

LAS VEGAS NV
01 SEP 2012

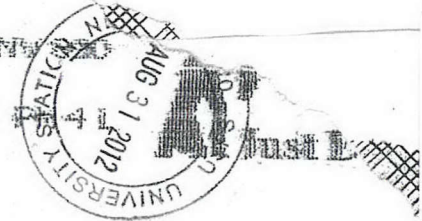

Arizona state office
one North Central Avenue
Suite 800

Phoenix, AZ 85004-4427

pm't

95004442700

United States Department of the Interior
Bureau of Land Management
 LANDS/RECREATION & PLANNING
 ONE N CENTRAL AVE
 PHOENIX, AZ 85004 -2203
 Phone: 602-417-9200

Receipt

No: 2651944

Transaction #: 2732770	
Date of Transaction: 09/07/2012	
CUSTOMER:	
BANDNA MISRA 3937 TROPICAL VINE ST LAS VEGAS,NV 89147-8076 US	

LINE #	QTY	DESCRIPTION	REMARKS	UNIT PRICE	TOTAL
1	1.00	LOCATABLE MINERALS / MINING CLAIMS-NOT NEW-UNADJUD,ONE AUTH NO. ONLY / MINING CLAIM MONEY RECEIVED CASES: AMC397893/\$1120.00	MAINT FEE PYMNT (8) 2013	- n/a -	1120.00
TOTAL:					\$1,120.00

PAYMENT INFORMATION			
NOTE: Items will appear on credit card statement as "Bureau of Land Mgmt CO".			
1	AMOUNT:	1120.00	POSTMARKED: N/A
	TYPE:	CREDIT CARD	RECEIVED: 09/05/2012
	NAME:	MISRA, BANDNA 3937 TROPICAL VINE ST LAS VEGAS NV 89147-8076 US	
	CARD NO:	XXXXXXXXXXXX5774	AUTH CODE: 00729B
	NAME ON CARD:	MISRA BANDNA	
	EXPIRES:	03/2016	
	SIGNATURE:		

REMARKS

This receipt was generated by the automated BLM Collections and Billing System and is a paper representation of a portion of the official electronic record contained therein.

AMC 397893

AMC 397901

August 22, 2011

Bandna Misra
NGH Foundation
3937 Tropical Vine St
Las Vegas, Nevada 89147

BLM Arizona
One North Central Avenue
Suite 800
Phoenix, Arizona 85004

RE: Payment of annual fees for four Mining Claims in Arizona

Claims:

1. AMC 397893
2. AMC 397894
3. AMC 397895
4. AMC 397896

I am attaching a check payable to "BLM" for (\$140) X (Four Claims) = \$560.

Thank you

Bandna Misra

RECEIVED
BLM AZ STATE OFFICE
2011 AUG 25 A 8:55
PHOENIX, ARIZONA

NO. OF CLAIMS 4
AMOUNT 560.00
RECEIPT NO. 2414942
INIT. SP
** BLM-ASO **

ENTERED INTO COMPUTER

SEP 06 2011

August 22, 2011

Bandna Misra
NGH Foundation
3937 Tropical Vine St
Las Vegas, Nevada 89147

BLM Arizona
One North Central Avenue
Suite 800
Phoenix, Arizona 85004

RE: Payment of annual fees for four Mining Claims in Arizona

Claims:

1. AMC 397901
2. AMC 397902
3. AMC 397903
4. AMC 397904

I am attaching a check payable to "BLM" for (\$140) X (Four Claims) = \$560.

Thank you

Bandna Misra

RECEIVED
BLM AZ STATE OFFICE
2011 AUG 25 A 8:55
PHOENIX, ARIZONA

NO. OF CLAIMS 4
AMOUNT 560.00
RECEIPT NO. 2414946
INIT. SP
** BLM-ASO **

United States Department of the Interior
Bureau of Land Management
 LANDS/RECREATION & PLANNING
 ONE N CENTRAL AVE
 PHOENIX, AZ 85004 -2203
 Phone: 602-417-9200

Receipt

No: 2414942

Transaction #: 2490310	
Date of Transaction: 08/25/2011	
CUSTOMER:	
BANDNA MISRA 3937 TROPICAL VINE ST LAS VEGAS,NV 89147-8076 US	

LINE #	QTY	DESCRIPTION	REMARKS	UNIT PRICE	TOTAL
1	1.00	LOCATABLE MINERALS / MINING CLAIMS-NOT NEW-UNADJUD,ONE AUTH NO. ONLY / MINING CLAIM MONEY RECEIVED CASES: AMC397893/\$560.00	MAINT-4	- n/a -	560.00
TOTAL:					\$560.00

PAYMENT INFORMATION					
1	AMOUNT:	560.00	POSTMARKED:	N/A	
	TYPE:	CHECK	RECEIVED:	08/25/2011	
	CHECK NO:	2580			
	NAME:	MISRA, BANDNA 3937 TROPICAL VINE ST LAS VEGAS NV 89147-8076 US			

REMARKS

This receipt was generated by the automated BLM Collections and Billing System and is a paper representation of a portion of the official electronic record contained therein.

United States Department of the Interior
Bureau of Land Management
 LANDS/RECREATION & PLANNING
 ONE N CENTRAL AVE
 PHOENIX, AZ 85004 -2203
 Phone: 602-417-9200

Receipt

No: 2414946

Transaction #: 2490312	
Date of Transaction: 08/25/2011	
CUSTOMER:	
BANDNA MISRA 3937 TROPICAL VINE ST LAS VEGAS,NV 89147-8076 US	

LINE #	QTY	DESCRIPTION	REMARKS	UNIT PRICE	TOTAL
1	1.00	LOCATABLE MINERALS / MINING CLAIMS-NOT NEW-UNADJUD,ONE AUTH NO. ONLY / MINING CLAIM MONEY RECEIVED CASES: AMC397901/\$560.00	MAINT-4	- n/a -	560.00
TOTAL:					\$560.00

PAYMENT INFORMATION					
1	AMOUNT:	560.00	POSTMARKED:	N/A	
	TYPE:	CHECK	RECEIVED:	08/25/2011	
	CHECK NO:	2579			
	NAME:	MISRA, BANDNA 3937 TROPICAL VINE ST LAS VEGAS NV 89147-8076 US			

REMARKS

This receipt was generated by the automated BLM Collections and Billing System and is a paper representation of a portion of the official electronic record contained therein.

Bandna Misra
NGH Foundation
3937 Tropical Vine St
Las Vegas, NV 89147

RECEIVED
BLM AZ STATE OFFICE
2011 AUG 24 P 12:22
PHOENIX, ARIZONA

560

LAS VEGAS NV 890
22 AUG 2011 PM 4 T

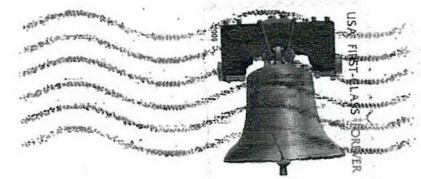

BLM Arizona
one North central Avenue
Suite 800
Phoenix, Arizona 85004

85004+4427

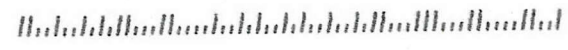

Bandna Misra
NGH Foundation
3937 Tropical Vine St
Las Vegas, NV 89147

RECEIVED
BLM AZ STATE OFFICE
2011 AUG 24 P 12:30
PHOENIX, ARIZONA

560

LAS VEGAS NV 890
22 AUG 2011 PM 4 T

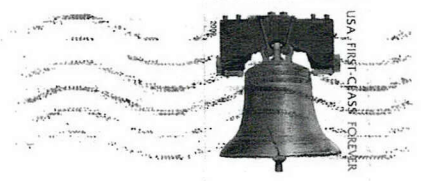

BLM Arizona
one North central Avenue
Suite 800
Phoenix, Arizona 85004

85004+4427

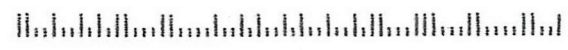

AMC 397901
397893

MAINTENANCE FEE PAYMENT

Claimant Name: Bandna Misra + NGHF
 Address: 3937 Tropical Vine St.
 City: Las Vegas State: NV Zip: 89147
 Telephone: 702-869-5442
 E-mail address: Vandeepak@aol.com
 Signature: Bandna Misra

RECEIVED
 BLM AZ STATE OFFICE
 2010 AUG 30 A 8:14
 PHOENIX, ARIZONA
 BLM
 Date
 Stamp

Check here if this is a change of address.

LINE NO.	AMC NUMBER	CLAIM/SITE NAME	COUNTY RECORDER DATA (If available)	TWP	RNG	SEC
1	397893	Manj-1				
2	397894	Manj-2				
3	397895	Manj-3				
4	397896	Manj-4				
5	397901	Jas-1				
6	397902	Jas-2				
7	397903	Jas-3				
8	397904	Jas-4				
9						
10						

List additional claims on Form MCF114.

Bureau of Land Management
 Arizona State Office
 www.blm.gov/az/

No. of Claims: 8 x \$140 = \$1120.00
 Check No: _____ Init. [Signature]
 Receipt No.: 2207254
 For BLM Use Only

Form: MCF112
 Revised July 2009

This form is available from the Arizona Department of Mines and Mineral Resources and may be reproduced.

ENTERED INTO COMPUTER SEP 19 2010
 M

United States Department of the Interior
Bureau of Land Management
 LANDS/RECREATION & PLANNING
 ONE N CENTRAL AVE
 PHOENIX, AZ 85004 -2203
 Phone:

Receipt

No: 2207254

Transaction #: 2277269	
Date of Transaction: 09/01/2010	
CUSTOMER:	
BANDNA MISRA 3937 TROPICAL VINE ST LAS VEGAS,NV 89147-8076 US	ENTERED INTO COMPUTER SEP 19 2010 <i>M</i>

LINE #	QTY	DESCRIPTION	REMARKS	UNIT PRICE	TOTAL
1	1.00	LOCATABLE MINERALS / MINING CLAIMS-NOT NEW-UNADJUD,ONE AUTH NO. ONLY / MINING CLAIM MONEY RECEIVED CASES: AMC397893/\$1120.00	MAINT 2011-8	- n/a -	1120.00
TOTAL:					\$1,120.00

PAYMENT INFORMATION					
1	AMOUNT:	1120.00	POSTMARKED:	N/A	
	TYPE:	CHECK	RECEIVED:	09/01/2010	
	CHECK NO:	2058			
	NAME:	MISRA, BANDNA 3937 TROPICAL VINE ST LAS VEGAS NV 89147-8076 US			

REMARKS

This receipt was generated by the automated BLM Collections and Billing System and is a paper representation of a portion of the official electronic record contained therein.

Authorized Date08/25/2010

AZ BLM REFND \$211 TO BANDNA MISRA FOR LOC AND MAINT

Instructions to AccountsFEES PAID ON CLOSED CLAIMS AMC397897-397900 RECEIPT
#2010939 AT

Login ID2393

Entry Date08/25/2010

Total Amount\$211.00

**DEPARTMENT OF THE INTERIOR
BUREAU OF LAND MANAGEMENT
MINING CLAIMS**

Run Date/Time: 10/20/2009 01:21 PM

(LIVE) Serial Register Page

Page 1 of 1

01 05-10-1872;017STAT0091;30USC26,28,34
Case Type 384101: LODE CLAIM
Claim Name: JAS-1
Commodity :
Case Disposition: ACTIVE

**Serial Number
AMC397901
Lead File Number
AMC397901**

Name & Address				Int Rel	% Interest
NEHA GUPTA HUMANITARIAN FNI	3937	TROPICAL VINE ST	LAS VEGAS, NV 89147-8076	CLAIMANT	0.0000000
MISRA BANDNA	3937	TROPICAL VINE ST	LAS VEGAS, NV 89147-8076	CLAIMANT	0.0000000
Mer Twp	Rng	Sec	Quadrant	District/Resource	County
14	0150N	0130W	008 NW	KINGMAN FIELD OFFICE	MOHAVE

Act Date	Code	Action	Action Remarks	Receipt Number
07/21/2009	403	LOCATION DATE		
10/06/2009	395	RECORDATION NOTICE RECD	1	2011531
10/06/2009	484	LOCATION YEAR / MAINTENANCE	2009	2011531
10/01/2009	501	ACCT ADV IN LEAD FILE	AMC397901-397908	
07/22/2009	404	COUNTY RECORDATION	0;7542;367	

Line Nr Remarks

**NO WARRANTY IS MADE BY BLM
FOR USE OF THE DATA FOR
PURPOSES NOT INTENDED BY BLM**

Ame 397901 - 908

All 8 claims were

located 7/21/09.

claimant did not

pay for the 2010

assessment year.

(notices rec'd ^{ps} 10-1-09)

**DEPARTMENT OF THE INTERIOR
BUREAU OF LAND MANAGEMENT
MINING CLAIMS**

Run Date/Time: 10/20/2009 01:22 PM

(LIVE) Serial Register Page

Page 1 of 1

01 05-10-1872;017STAT0091;30USC26,28,34
Case Type 384101: LODE CLAIM
Claim Name: JAS-2
Commodity :
Case Disposition: ACTIVE

**Serial Number
AMC397902
Lead File Number
AMC397901**

Name & Address				Int Rel	% Interest	
NEHA GUPTA HUMANITARIAN FNI 3937 TROPICAL VINE ST				LAS VEGAS, NV 89147-8076	CLAIMANT	0.0000000
MISRA BANDNA 3937 TROPICAL VINE ST				LAS VEGAS, NV 89147-8076	CLAIMANT	0.0000000
Mer Twp	Rng	Sec	Quadrant	District/Resource	County	
14	0150N	0130W	008	NW	KINGMAN FIELD OFFICE	MOHAVE

Act Date	Code	Action	Action Remarks	Receipt Number
07/21/2009	403	LOCATION DATE		
10/06/2009	395	RECORDATION NOTICE RECD	1	2011531
10/06/2009	484	LOCATION YEAR / MAINTENANCE 2009		2011531
10/01/2009	501	ACCT ADV IN LEAD FILE	AMC397901-397908	
07/22/2009	404	COUNTY RECORDATION	0;7542;370	

Line Nr Remarks

**NO WARRANTY IS MADE BY BLM
FOR USE OF THE DATA FOR
PURPOSES NOT INTENDED BY BLM**

**DEPARTMENT OF THE INTERIOR
BUREAU OF LAND MANAGEMENT
MINING CLAIMS**

Run Date/Time: 10/20/2009 01:22 PM

(LIVE) Serial Register Page

Page 1 of 1

01 05-10-1872;017STAT0091;30USC26,28,34
Case Type 384101: LODE CLAIM
Claim Name: JAS-3
Commodity :
Case Disposition: ACTIVE

**Serial Number
AMC397903
Lead File Number
AMC397901**

Name & Address				Int Rel	% Interest
NEHA GUPTA HUMANITARIAN FNI 3937 TROPICAL VINE ST				LAS VEGAS, NV 89147-8076 CLAIMANT	0.0000000
MISRA BANDNA 3937 TROPICAL VINE ST				LAS VEGAS, NV 89147-8076 CLAIMANT	0.0000000
Mer Twp	Rng	Sec	Quadrant	District/Resource	County
14	0150N	0130W	008	NW	KINGMAN FIELD OFFICE MOHAVE

Act Date	Code	Action	Action Remarks	Receipt Number
07/21/2009	403	LOCATION DATE		
10/06/2009	395	RECORDATION NOTICE RECD	1	2011531
10/06/2009	484	LOCATION YEAR / MAINTENANCE 2009		2011531
10/01/2009	501	ACCT ADV IN LEAD FILE	AMC397901-397908	
07/22/2009	404	COUNTY RECORDATION	0;7542;373	

Line Nr Remarks

**NO WARRANTY IS MADE BY BLM
FOR USE OF THE DATA FOR
PURPOSES NOT INTENDED BY BLM**

**DEPARTMENT OF THE INTERIOR
BUREAU OF LAND MANAGEMENT
MINING CLAIMS**

Run Date/Time: 10/20/2009 01:23 PM

(LIVE) Serial Register Page

Page 1 of 1

01 05-10-1872;017STAT0091;30USC26,28,34
Case Type 384101: LODE CLAIM
Claim Name: JAS-4
Commodity :
Case Disposition: ACTIVE

**Serial Number
AMC397904
Lead File Number
AMC397901**

Name & Address				Int Rel	% Interest	
NEHA GUPTA HUMANITARIAN FNI 3937 TROPICAL VINE ST				LAS VEGAS, NV 89147-8076	CLAIMANT	0.0000000
MISRA BANDNA 3937 TROPICAL VINE ST				LAS VEGAS, NV 89147-8076	CLAIMANT	0.0000000
Mer Twp	Rng	Sec	Quadrant	District/Resource	County	
14	0150N	0130W	008	NW	KINGMAN FIELD OFFICE	MOHAVE

Act Date	Code	Action	Action Remarks	Receipt Number
07/21/2009	403	LOCATION DATE		
10/06/2009	395	RECORDATION NOTICE RECD	1	2011531
10/06/2009	484	LOCATION YEAR / MAINTENANCE	2009	2011531
10/01/2009	501	ACCT ADV IN LEAD FILE	AMC397901-397908	
07/22/2009	404	COUNTY RECORDATION	0;7542;376	

Line Nr Remarks

**NO WARRANTY IS MADE BY BLM
FOR USE OF THE DATA FOR
PURPOSES NOT INTENDED BY BLM**

**DEPARTMENT OF THE INTERIOR
BUREAU OF LAND MANAGEMENT
MINING CLAIMS**

Run Date/Time: 10/20/2009 01:24 PM

(LIVE) Serial Register Page

Page 1 of 1

01 05-10-1872;017STAT0091;30USC26,28,34
Case Type 384101: LODE CLAIM
Claim Name: JAS-5
Commodity :
Case Disposition: ACTIVE

**Serial Number
AMC397905
Lead File Number
AMC397901**

Name & Address				Int Rel	% Interest
NEHA GUPTA HUMANITARIAN FNI 3937 TROPICAL VINE ST				LAS VEGAS, NV 89147-8076 CLAIMANT	0.0000000
MISRA BANDNA 3937 TROPICAL VINE ST				LAS VEGAS, NV 89147-8076 CLAIMANT	0.0000000
Mer Twp	Rng	Sec	Quadrant	District/Resource	County
14	0150N	0130W	008 NW	KINGMAN FIELD OFFICE	MOHAVE

Act Date	Code	Action	Action Remarks	Receipt Number
07/21/2009	403	LOCATION DATE		
10/06/2009	395	RECORDATION NOTICE RECD	1	2011531
10/06/2009	484	LOCATION YEAR / MAINTENANCE 2009		2011531
10/01/2009	501	ACCT ADV IN LEAD FILE	AMC397901-397908	
07/22/2009	404	COUNTY RECORDATION	0;7542;379	

Line Nr Remarks

**NO WARRANTY IS MADE BY BLM
FOR USE OF THE DATA FOR
PURPOSES NOT INTENDED BY BLM**

**DEPARTMENT OF THE INTERIOR
BUREAU OF LAND MANAGEMENT
MINING CLAIMS**

Run Date/Time: 10/20/2009 01:25 PM

(LIVE) Serial Register Page

Page 1 of 1

01 05-10-1872;017STAT0091;30USC26,28,34
Case Type 384101: LODE CLAIM
Claim Name: JAS-6
Commodity :
Case Disposition: ACTIVE

**Serial Number
AMC397906
Lead File Number
AMC397901**

Name & Address				Int Rel	% Interest	
NEHA GUPTA HUMANITARIAN FNI 3937 TROPICAL VINE ST				LAS VEGAS, NV 89147-8076	CLAIMANT	0.0000000
MISRA BANDNA 3937 TROPICAL VINE ST				LAS VEGAS, NV 89147-8076	CLAIMANT	0.0000000
Mer Twp	Rng	Sec	Quadrant	District/Resource	County	
14	0150N	0130W	008 NW	KINGMAN FIELD OFFICE	MOHAVE	

Act Date	Code	Action	Action Remarks	Receipt Number
07/21/2009	403	LOCATION DATE		
10/06/2009	395	RECORDATION NOTICE RECD	1	2011531
10/06/2009	484	LOCATION YEAR / MAINTENANCE	2009	2011531
10/01/2009	501	ACCT ADV IN LEAD FILE	AMC397901-397908	
07/22/2009	404	COUNTY RECORDATION	0;7542;382	

Line Nr Remarks

**NO WARRANTY IS MADE BY BLM
FOR USE OF THE DATA FOR
PURPOSES NOT INTENDED BY BLM**

**DEPARTMENT OF THE INTERIOR
BUREAU OF LAND MANAGEMENT
MINING CLAIMS**

Run Date/Time: 10/20/2009 01:25 PM

(LIVE) Serial Register Page

Page 1 of 1

01 05-10-1872;017STAT0091;30USC26,28,34
Case Type 384101: LODE CLAIM
Claim Name: JAS-7
Commodity :
Case Disposition: ACTIVE

**Serial Number
AMC397907
Lead File Number
AMC397901**

Name & Address				Int Rel	% Interest	
NEHA GUPTA HUMANITARIAN FNI 3937 TROPICAL VINE ST				LAS VEGAS, NV 89147-8076	CLAIMANT	0.0000000
MISRA BANDNA 3937 TROPICAL VINE ST				LAS VEGAS, NV 89147-8076	CLAIMANT	0.0000000
Mer Twp	Rng	Sec	Quadrant	District/Resource	County	
14	0150N	0130W	008	NW	KINGMAN FIELD OFFICE	MOHAVE

Act Date	Code	Action	Action Remarks	Receipt Number
07/21/2009	403	LOCATION DATE		
10/06/2009	395	RECORDATION NOTICE RECD	1	2011531
10/06/2009	484	LOCATION YEAR / MAINTENANCE 2009		2011531
10/01/2009	501	ACCT ADV IN LEAD FILE	AMC397901-397908	
07/22/2009	404	COUNTY RECORDATION	0;7542;385	

Line Nr Remarks

**NO WARRANTY IS MADE BY BLM
FOR USE OF THE DATA FOR
PURPOSES NOT INTENDED BY BLM**

**DEPARTMENT OF THE INTERIOR
BUREAU OF LAND MANAGEMENT
MINING CLAIMS**

Run Date/Time: 10/20/2009 01:26 PM

(LIVE) Serial Register Page

Page 1 of 1

01 05-10-1872;017STAT0091;30USC26,28,34
Case Type 384101: LODE CLAIM
Claim Name: JAS-8
Commodity :
Case Disposition: ACTIVE

**Serial Number
AMC397908
Lead File Number
AMC397901**

Name & Address				Int Rel	% Interest
NEHA GUPTA HUMANITARIAN FNI 3937 TROPICAL VINE ST				LAS VEGAS, NV 89147-8076 CLAIMANT	0.0000000
MISRA BANDNA 3937 TROPICAL VINE ST				LAS VEGAS, NV 89147-8076 CLAIMANT	0.0000000
Mer Twp	Rng	Sec	Quadrant	District/Resource	County
14	0150N	0130W	008 NW	KINGMAN FIELD OFFICE	MOHAVE

Act Date	Code	Action	Action Remarks	Receipt Number
07/21/2009	403	LOCATION DATE		
10/06/2009	395	RECORDATION NOTICE RECD	1	2011531
10/06/2009	484	LOCATION YEAR / MAINTENANCE 2009		2011531
10/01/2009	501	ACCT ADV IN LEAD FILE	AMC397901-397908	
07/22/2009	404	COUNTY RECORDATION	0;7542;388	

Line Nr Remarks

**NO WARRANTY IS MADE BY BLM
FOR USE OF THE DATA FOR
PURPOSES NOT INTENDED BY BLM**

NOTICE!!

These documents have been scanned!

Do not place un-scanned documents beneath this notice!

Do not remove this notice from this file!

GPO Jacket No. 560-102
Print Order 61540
Rise Business Services, LLC
Job=AZ15 5/20/2019



Box Number= AZ15070



Claim Begin-End: AMC397901-AMC397908

5 Miscellaneous



AZ15070-12

AMC397273-AMC397967

**NO
DOCUMENTS
FOUND**

NO DOCUMENTS FOUND
NO DOCUMENTS FOUND

NOTICE!!

These documents have been scanned!

Do not place un-scanned documents beneath this notice!

Do not remove this notice from this file!

GPO Jacket No. 560-102
Print Order 61540
Rise Business Services, LLC
Job=AZ15 5/20/2019



Box Number= AZ15070



Claim Begin-End: AMC397901-AMC397908

6 Location Notices-Amendments and Supporting Documents



AZ15070-12

AMC397273-AMC397967

MINING CLAIM STATUS REPORT

DATA ENTERED _____

MTP Checked by _____

GEO Checked by _____

LEAD SERIAL NUMBER AMC 397901 thru AMC 397908

OF CLAIMS & TYPE

8 LODE
_____ PLACER
_____ ASSOCIATION PLACER
_____ MILL SITE
_____ TUNNEL SITE

CHARGES

Location Fee @ \$34 = \$ 272
Processing Fee @ \$15 = \$ 120
Maintenance Fee @ \$140 = \$ 1,120
Overage (+) \$ _____
Shortage (-) \$ 1,120
Other Fees \$ _____
TOTAL \$ 1,512

Missing 09 maint fees

ARE THERE ENOUGH LOCATORS?

Yes () No () _____

DOCUMENTS RECEIVED VIA -

Over-the-Counter () Mail ()

TIMELY FILED?

Yes () No ()

LEGAL DESCRIPTION -

T 15W R 13W SEC 8
T _____ R _____ SEC _____
T _____ R _____ SEC _____
T _____ R _____ SEC _____

BLM () FOREST SERVICE () _____ SUBJ TO PL 359: Yes () No ()

WILDERNESS AREA: No () Yes () _____

SPLIT ESTATE - N/A () SX () PX () SRHA () OTHER () _____

Proper Notice Filed if Located on SHRA Lands? N/A () Yes () No ()

RECONVEYED MINERALS ON BLM LANDS REQUIRE OPENING ORDERS FROM 1944 TO 1993 -

Open to Entry on: _____ N/A ()

COMMENTS/STATUS - VOID () PARTIALLY VOID () PVT MINERALS () WITHDRAWN LANDS ()

OTHER () Last 4 claims closed 397905-397908 insufficient fees - located in July, filed in Oct. No 2010 maintenance Fee

Claimant acknowledges that portions of the following claims(s) site(s) may be void or voidable.

Printed Name of Claimant _____ Signature of Claimant _____

***** FINAL ADJUDICATION *****

DATE 8/19/10 INITIALS AT

AMC 397901

3



B: 7542 P: 367

OFFICIAL RECORDS
OF MOHAVE COUNTY
CAROL MEIER,
COUNTY RECORDER



07/22/2009 03:29 PM Fee: \$14.00
DOC TYPE: MINE
PAID BY: B MISRA & N G H E

LOCATION NOTICE FOR LODE MINING CLAIM

NOTICE IS HEREBY GIVEN that the JAS-1

- lode mining claim has been located

by B-MISRA & N-G-H-E whose current mailing
address is 3937 Tropical Vine St
Las Vegas, Nevada 89147

RECEIVED
BLM AZ STATE OFFICE
2009 OCT - 1 A 8: 04
PHOENIX, ARIZONA
BLM
Date
Stamp

The general course of this claim is west to east and it is situated in Mohave
County, Arizona. This claim is 1320 feet in length and 300 feet in width. This claim runs
from the location monument on which this location notice is posted ^(in center) approximately 300 feet in a
W direction to the west end line and 300 feet in a E direction to the
east end line. This claim is marked by six monuments, one at each corner and one at the center of each
end line of the claim.

The location monument on which this notice is posted is situated within Section 8, Township 15
N, Range 13 W, Gila Salt River Base and Meridian, Arizona and this claim encompasses portions
of the following quarter section (s), section (s), Township (s) and Range (s) NW 1/4; S 8;
T 15N; R 13W; Meridian 14

Gila Salt River Base and Meridian, Arizona.

The locality of this claim with reference to some natural object or permanent monument and additional information
(if any) concerning its locality are as follows: 1.5" x 1.5" Wooden Square
Posts; Four feet in length; Set one foot in
ground A 20 acres Lode Claim

DATED AND POSTED on the ground this 21 day of July, 2009.

LOCATOR (s) B - E M NGH
B-Misra, Trustee N-Gupta, President
N M Trust NGH Foundation

Form MCF100
Revised July 2005

AMC 397901

368

MINING CLAIM MAP

Lode () Placer ()

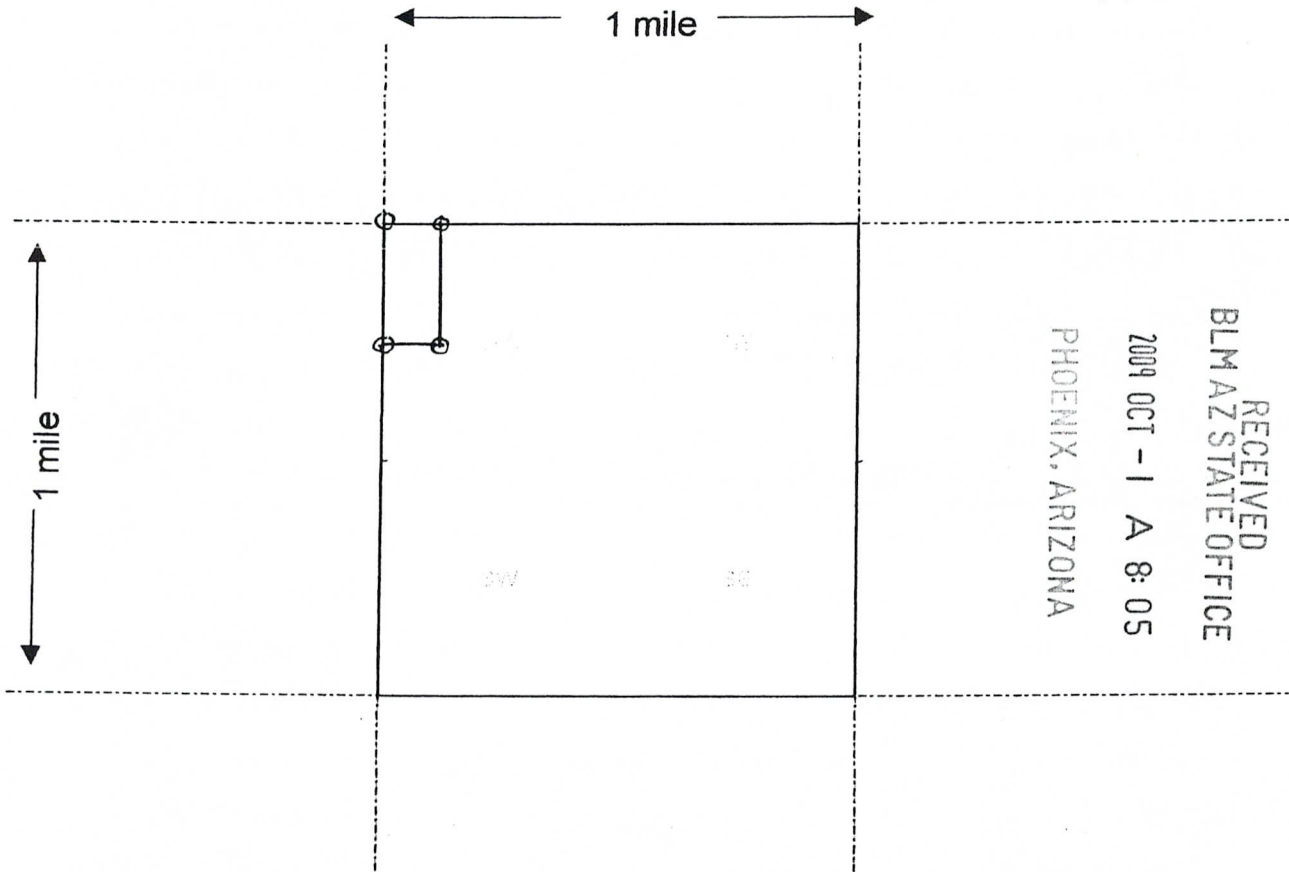

RECEIVED
 BLM AZ STATE OFFICE
 2009 OCT - 1 A 8:05
 PHOENIX, ARIZONA

Scale: 1" = 2000 feet



1. The above map depicts the JAS-1 mining claim, which is located in Section (s) 8, Township 15 N, Range 13 W, Gila and Salt River Base and Meridian, Mohave County, Arizona.

2. The type of corner and location monuments used are as follows: 1.5" x 1.5" Wooden Square Posts; Four feet long; Set one foot in ground.

3. The bearings and distances in degrees and feet between claim corners are as depicted on the map.

Form MCF100a
 Revised July 2005

This form is available from the Arizona Department of Mines & Mineral Resources and may be reproduced.

ANC 397901

369

DEED OF OWNERSHIP

Date: July 22, 2009

County of Mohave
State of Nevada

Location: 160 acres. Northwest Quarter, Section 8, Township 15 North, Range 13 West, Meridian 14. Near Wikieup, Arizona.

Owner of Record:

(1) Bandna Misra, Trustee of the Nevada Mining Trust dated August 1, 2006 as fifty percent (50%) Owner.

and

(2) Neha Gupta Humanitarian Foundation, a Nevada Corporation as fifty percent (50%) Owner.

All located at 3937 Tropical Vine St., Las Vegas, Nevada USA 89147

Staking and posting: July 21, 2009

Signed in Las Vegas on this 22nd day of July, 2009

RECEIVED
BLM AZ STATE OFFICE
2009 OCT - 1 A 8:05
PHOENIX, ARIZONA

AMC 397901



Bandna Misra, Trustee



Neha Gupta, President

B: 7542 P: 370

OFFICIAL RECORDS
OF MOHAVE COUNTY
CAROL MEIER
COUNTY RECORDER



07/22/2009 03:29 PM Fee: \$14.00
DOC TYPE: MINE
PAID BY: B MISRA & N G H E

LOCATION NOTICE FOR LODE MINING CLAIM

NOTICE IS HEREBY GIVEN that the JAS-2
lode mining claim has been located

by B. MISRA & N. G. H. E. whose current mailing
address is 3937 Tropical Vine St
Las Vegas, Nevada 89147.

RECEIVED
BLM AZ STATE OFFICE
2009 OCT - 1 A 8:05
PHOENIX, ARIZONA
BLM
Date
Stamp

The general course of this claim is west to east and it is situated in Mohave
County, Arizona. This claim is 1320 feet in length and 300 feet in width. This claim runs
from the location monument on which this location notice is posted (in center) approximately 300 feet in a
W direction to the west end line and 300 feet in a E direction to the
east end line. This claim is marked by six monuments, one at each corner and one at the center of each
end line of the claim.

The location monument on which this notice is posted is situated within Section 8, Township 15
N, Range 13 W, Gila Salt River Base and Meridian, Arizona and this claim encompasses portions
of the following quarter section (s), section (s), Township (s) and Range (s) NW 1/4; S 8;
T 15 N; R 13 W; Meridian 14

Gila Salt River Base and Meridian, Arizona.

The locality of this claim with reference to some natural object or permanent monument and additional information
(if any) concerning its locality are as follows: 1.5" x 1.5" Wooden Square
Posts; Four feet in length; Set one foot in
ground. A 20 acres Lode Claim

DATED AND POSTED on the ground this 21 day of July, 2009.

LOCATOR (s) B. Misra, Trustee N. Gupta, President
N.M Trust NGH Foundation

Form MCF100
Revised July 2005

ANC 397902

371

MINING CLAIM MAP

Lode () Placer ()

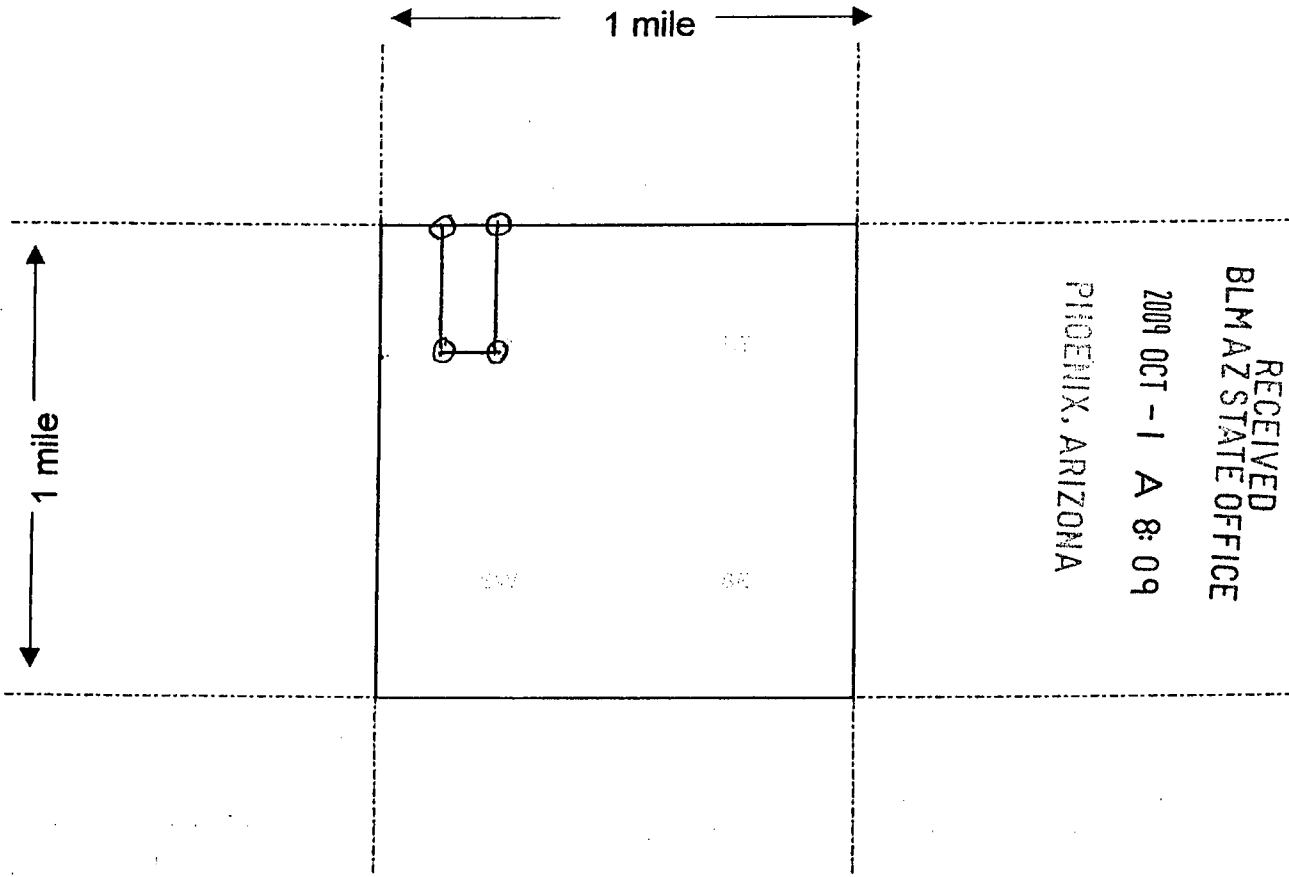

Scale: 1" = 2000 feet



1. The above map depicts the JAS-2 mining claim, which is located in Section (s) 8, Township 15 N, Range 13 W, Gila and Salt River Base and Meridian, Mohave County, Arizona.

2. The type of corner and location monuments used are as follows: 1.5" x 1.5" Wooden Square Posts; Four feet long; set one foot in ground

3. The bearings and distances in degrees and feet between claim corners are as depicted on the map.

Form MCF100a
Revised July 2005

This form is available from the Arizona Department of Mines & Mineral Resources and may be reproduced.

AMC 397902

372

DEED OF OWNERSHIP

Date: July 22, 2009

County of Mohave
State of Nevada

Location: 160 acres. Northwest Quarter, Section 8, Township 15 North, Range 13 West, Meridian 14. Near Wikieup, Arizona.

Owner of Record:

(1) Bandna Misra, Trustee of the Nevada Mining Trust dated August 1, 2006 as fifty percent (50%) Owner.

and

(2) Neha Gupta Humanitarian Foundation, a Nevada Corporation as fifty percent (50%) Owner.

All located at 3937 Tropical Vine St., Las Vegas, Nevada USA 89147

Staking and posting: July 21, 2009

Signed in Las Vegas on this 22nd day of July, 2009

RECEIVED
BLM AZ STATE OFFICE
2009 OCT - 1 A 8:09
PHOENIX, ARIZONA

AMC 397902

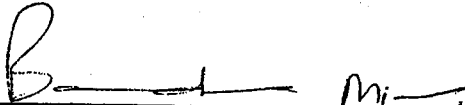

Bandna Misra, Trustee



Neha Gupta, President

B: 7542 P: 373

OFFICIAL RECORDS OF MOHAVE COUNTY CAROL MEIER, COUNTY RECORDER



07/22/2009 03:29 PM Fee: \$14.00 DOC TYPE: MINE PAID BY: B MISRA & N G H E

LOCATION NOTICE FOR LODE MINING CLAIM

NOTICE IS HEREBY GIVEN that the JAS-3

lode mining claim has been located

by B. MISRA & N. G. H. E. whose current mailing address is 3937 Tropical Vine St Las Vegas, Nevada 89147.

RECEIVED BLM AZ STATE OFFICE 2009 OCT - 1 A 8:09 PHOENIX, ARIZONA

The general course of this claim is west to east and it is situated in Mohave County, Arizona. This claim is 1320 feet in length and 300 feet in width. This claim runs from the location monument on which this location notice is posted (in center) approximately 300 feet in a W direction to the west end line and 300 feet in a E direction to the east end line. This claim is marked by six monuments, one at each corner and one at the center of each end line of the claim.

The location monument on which this notice is posted is situated within Section 8, Township 15 N, Range 13 W, Gila Salt River Base and Meridian, Arizona and this claim encompasses portions of the following quarter section (s), section (s), Township (s) and Range (s) NW 1/4; S 8; T 15N; R 13W; Meridian 14

Gila Salt River Base and Meridian, Arizona.

The locality of this claim with reference to some natural object or permanent monument and additional information (if any) concerning its locality are as follows: 1.5" x 1.5" Wooden Square Posts; Four feet in length; Set one foot in ground. A 20 acres Lode Claim

DATED AND POSTED on the ground this 21 day of July, 2009.

LOCATOR (s) B. Misra, Trustee N. Gupta, President
NM Trust NGH Foundation

Form MCF100 Revised July 2005

AMC 397903

374

MINING CLAIM MAP

Lode () Placer ()

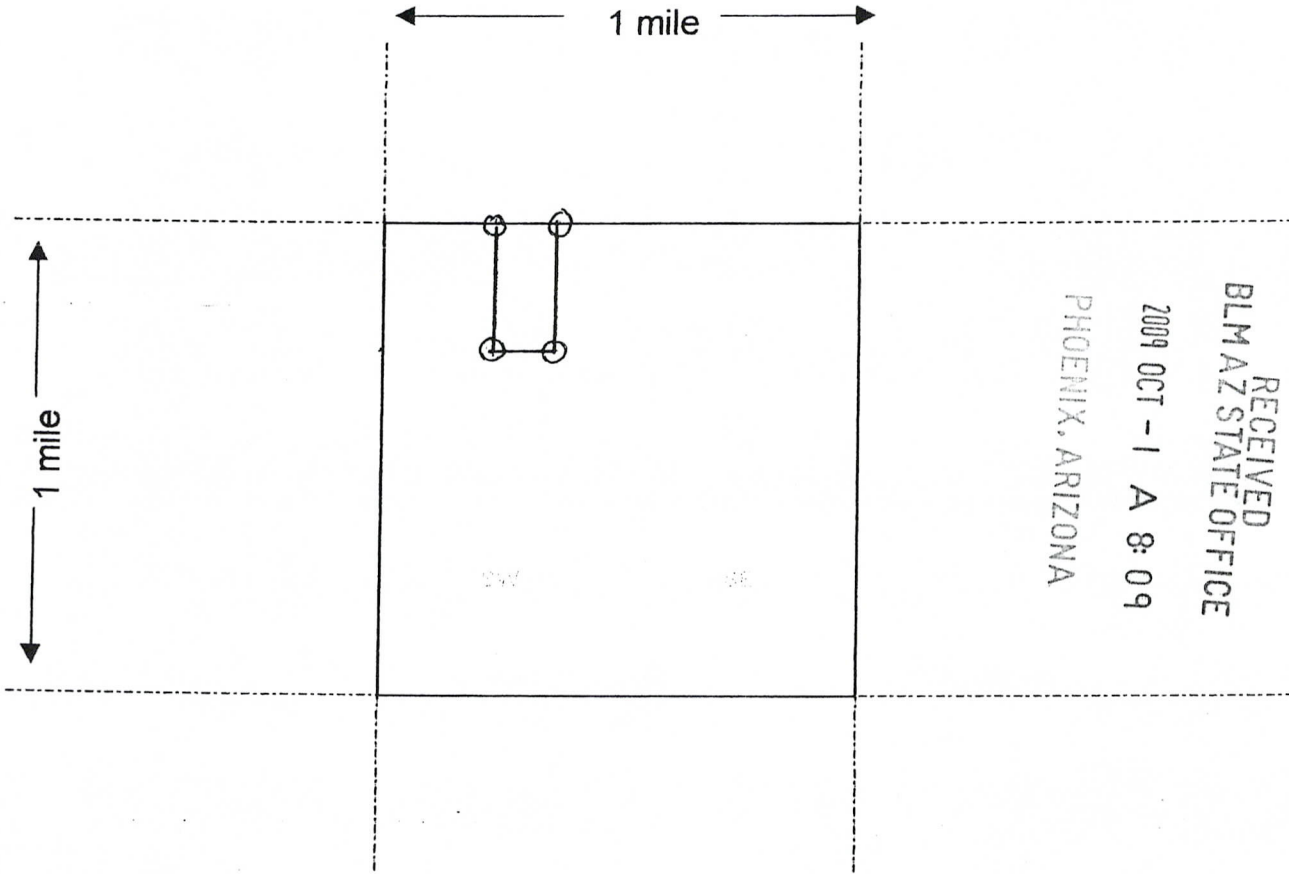

RECEIVED
BLM AZ STATE OFFICE
2009 OCT - 1 A 8: 09
PHOENIX, ARIZONA

Scale : 1" = 2000 feet



1. The above map depicts the JAS - 3 mining claim, which is located in Section (s) 8, Township 15 N, Range 13 W, Gila and Salt River Base and Meridian, Mohave County, Arizona.

2. The type of corner and location monuments used are as follows: 1.5" x 1.5" Wooden Square Posts; Four feet long; Set one foot in ground.

3. The bearings and distances in degrees and feet between claim corners are as depicted on the map.

Form MCF100a
Revised July 2005

This form is available from the Arizona Department of Mines & Mineral Resources and may be reproduced.

ANC 397903

DEED OF OWNERSHIP

375

Date: July 22, 2009

County of Mohave
State of Nevada

Location: 160 acres. Northwest Quarter, Section 8, Township 15 North, Range 13 West, Meridian 14. Near Wikieup, Arizona.

Owner of Record:

(1) Bandna Misra, Trustee of the Nevada Mining Trust dated August 1, 2006 as fifty percent (50%) Owner.

and

(2) Neha Gupta Humanitarian Foundation, a Nevada Corporation as fifty percent (50%) Owner.

All located at 3937 Tropical Vine St., Las Vegas, Nevada USA 89147

Staking and posting: July 21, 2009

Signed in Las Vegas on this 22nd day of July, 2009



Bandna Misra, Trustee



Neha Gupta, President

AMC 397903

RECEIVED
BLM AZ STATE OFFICE
2009 OCT - 1 A 8: 10
PHOENIX, ARIZONA

3



B: 7542 P: 376

OFFICIAL RECORDS OF MOHAVE COUNTY CAROL MEIER, COUNTY RECORDER



07/22/2009 03:29 PM Fee: \$14.00

DOC TYPE: MINE PAID BY: B MISRA & N G H E

LOCATION NOTICE FOR LODE MINING CLAIM

NOTICE IS HEREBY GIVEN that the JAS-4

- lode mining claim has been located

by B. MISRA & N. G. H. E. whose current mailing address is 3937 Tropical Vine St Las Vegas, Nevada 89147.

RECEIVED
BLM AZ STATE OFFICE
2009 OCT - 1 A 8: 10
PHOENIX, ARIZONA

BLM
Date
Stamp

The general course of this claim is west to east and it is situated in Mohave County, Arizona. This claim is 1320 feet in length and 300 feet in width. This claim runs from the location monument on which this location notice is posted, approximately 300 feet in a W direction to the west end line and 300 feet in a E direction to the east end line. This claim is marked by six monuments, one at each corner and one at the center of each end line of the claim.

The location monument on which this notice is posted is situated within Section 8, Township 15 N, Range 13 W, Gila Salt River Base and Meridian, Arizona and this claim encompasses portions of the following quarter section (s), section (s), Township (s) and Range (s) NW 1/4; S 8; T 15N; R 13W; Meridian 14

Gila Salt River Base and Meridian, Arizona.

The locality of this claim with reference to some natural object or permanent monument and additional information (if any) concerning its locality are as follows: 1.5" x 1.5" Wooden Square Posts; Four feet in length; Set one foot in ground. A 20 acres Lode Claim

DATED AND POSTED on the ground this 21 day of July, 2009.

LOCATOR (s) B. Misra, Trustee N.M. Trust N. Gupta, President NGH Foundation

Form MCF100 Revised July 2005

AMC 397904

377

MINING CLAIM MAP

Lode () Placer ()

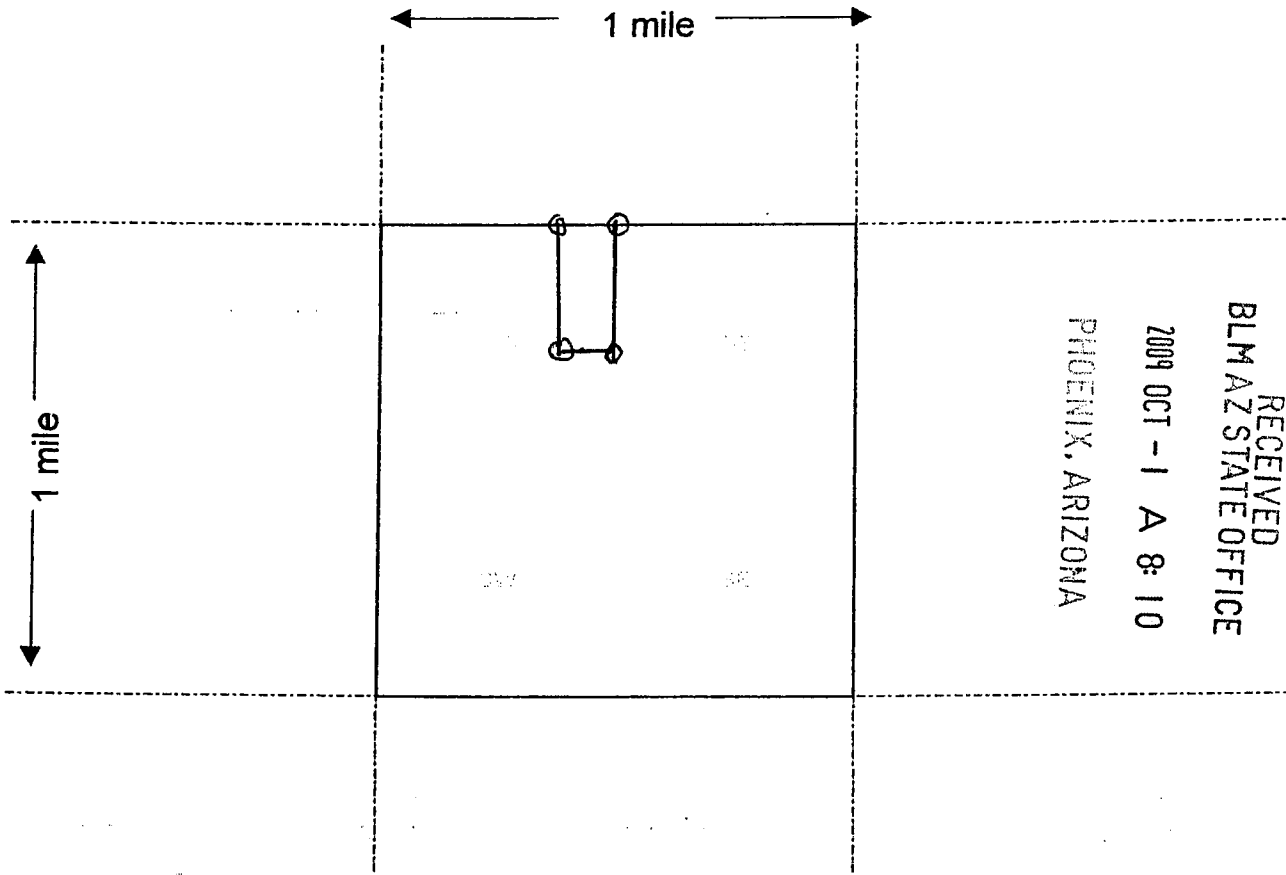

RECEIVED
BLM AZ STATE OFFICE
2009 OCT - 1 A 8: 10
PHOENIX, ARIZONA

Scale : 1" = 2000 feet



1. The above map depicts the JAS-4 mining claim, which is located in Section (s) 8, Township 15 N, Range 13 W, Gila and Salt River Base and Meridian, Mohave County, Arizona.

2. The type of corner and location monuments used are as follows: 1.5" x 1.5" Wooden Square Posts; Four feet long; Set one foot in ground

3. The bearings and distances in degrees and feet between claim corners are as depicted on the map.

Form MCF100a
Revised July 2005

This form is available from the Arizona Department of Mines & Mineral Resources and may be reproduced.

AMC 397904

378

DEED OF OWNERSHIP

Date: July 22, 2009

County of Mohave
State of Nevada

Location: 160 acres. Northwest Quarter, Section 8, Township 15 North, Range 13 West, Meridian 14. Near Wikieup, Arizona.

Owner of Record:

(1) Bandna Misra, Trustee of the Nevada Mining Trust dated August 1, 2006 as fifty percent (50%) Owner.

and

(2) Neha Gupta Humanitarian Foundation, a Nevada Corporation as fifty percent (50%) Owner.

All located at 3937 Tropical Vine St., Las Vegas, Nevada USA 89147

Staking and posting: July 21, 2009

Signed in Las Vegas on this 22nd day of July, 2009

RECEIVED
BLM AZ STATE OFFICE
2009 OCT - 1 A 8:10
PHOENIX, ARIZONA

AMC 397904

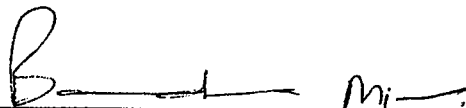

Bandna Misra, Trustee



Neha Gupta, President

B: 7542 P: 379

OFFICIAL RECORDS OF MOHAVE COUNTY CAROL MEIER, COUNTY RECORDER



07/22/2009 03:29 PM Fee: \$14.00 DOC TYPE: MINE PAID BY: B MISRA & N G H E

LOCATION NOTICE FOR LODE MINING CLAIM

NOTICE IS HEREBY GIVEN that the JAS-5

- lode mining claim has been located

by B. MISRA & N.G.H.E. whose current mailing address is 3937 Tropical Vine St Las Vegas, Nevada 89147.

RECEIVED
BLM AZ STATE OFFICE
2009 OCT -1 A 8:10
PHOENIX, ARIZONA
BLM
Date
Stamp

The general course of this claim is west to east and it is situated in Mohave County, Arizona. This claim is 1320 feet in length and 300 feet in width. This claim runs from the location monument on which this location notice is posted (in center) approximately 300 feet in a W direction to the west end line and 300 feet in a E direction to the east end line. This claim is marked by six monuments, one at each corner and one at the center of each end line of the claim.

The location monument on which this notice is posted is situated within Section 8, Township 15 N, Range 13 W, Gila Salt River Base and Meridian, Arizona and this claim encompasses portions of the following quarter section (s), section (s), Township (s) and Range (s) NW 1/4; S 8; T 15N; R 13W; Meridian 14

Gila Salt River Base and Meridian, Arizona.

The locality of this claim with reference to some natural object or permanent monument and additional information (if any) concerning its locality are as follows: 1.5" x 1.5" Wooden Square Posts; Four feet in length; Set one foot in ground. A 20 acres Lode Claim

DATED AND POSTED on the ground this 21 day of July, 2009.

LOCATOR (s) B. Misra, Trustee N. Gupta, President
NM Trust NGH Foundation

Form MCF100 Revised July 2005

AMC 397905

380

MINING CLAIM MAP

Lode () Placer ()

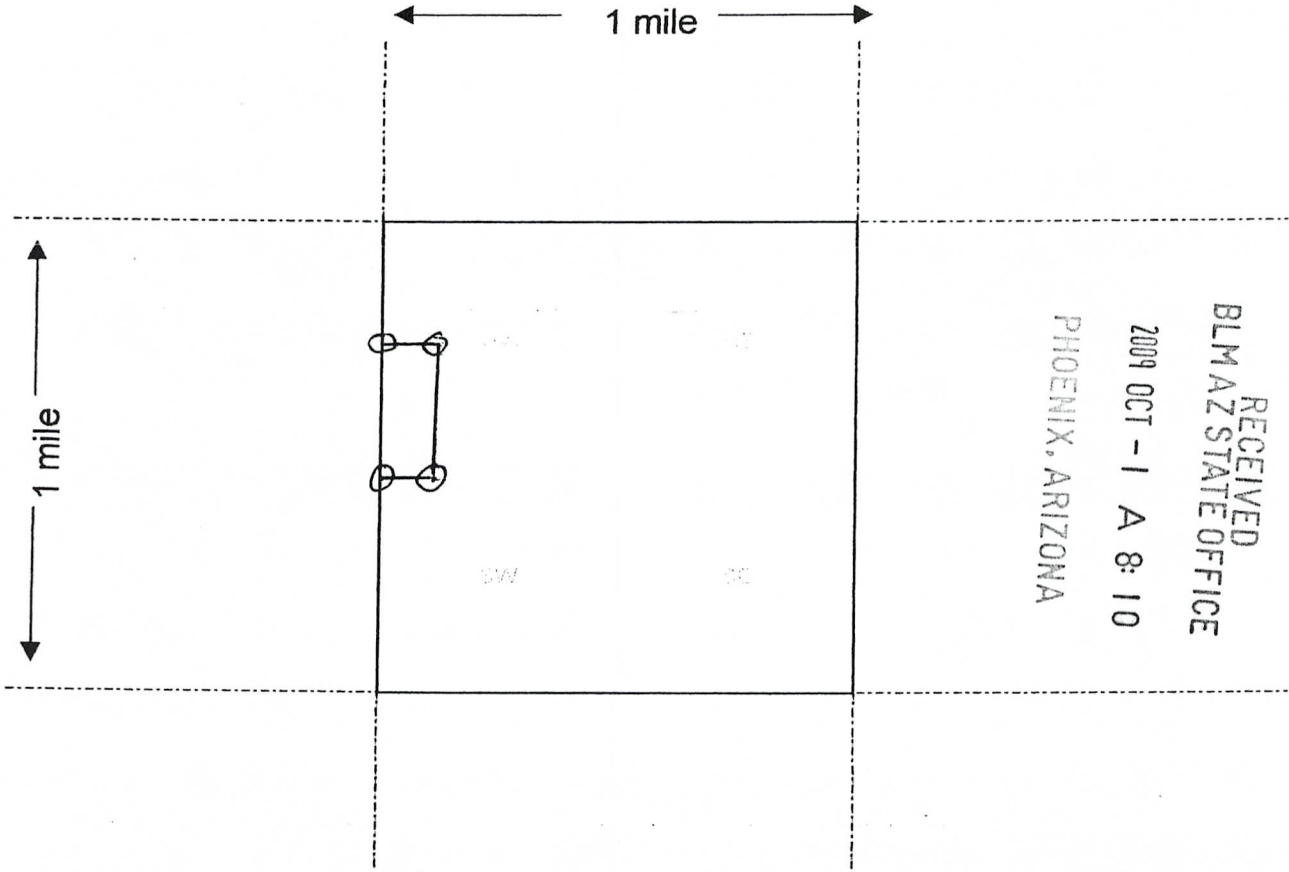

RECEIVED
 BLM AZ STATE OFFICE
 2009 OCT - 1 A 8: 10
 PHOENIX, ARIZONA

Scale : 1" = 2000 feet



1. The above map depicts the JAS-5 mining claim, which is located in Section (s) 8, Township 15 N, Range 13 W, Gila and Salt River Base and Meridian, Mohave County, Arizona.
2. The type of corner and location monuments used are as follows: 1.5" x 1.5" Wooden Square Posts; Four feet long; Set One foot in ground.
3. The bearings and distances in degrees and feet between claim corners are as depicted on the map.

Form MCF100a
 Revised July 2005

This form is available from the **Arizona Department of Mines & Mineral Resources** and may be reproduced.

AMC 397905

381

DEED OF OWNERSHIP

Date: July 22, 2009

County of Mohave
State of Nevada

Location: 160 acres. Northwest Quarter, Section 8, Township 15 North, Range 13 West, Meridian 14. Near Wikieup, Arizona.

Owner of Record:

(1) Bandna Misra, Trustee of the Nevada Mining Trust dated August 1, 2006 as fifty percent (50%) Owner.

and

(2) Neha Gupta Humanitarian Foundation, a Nevada Corporation as fifty percent (50%) Owner.

All located at 3937 Tropical Vine St., Las Vegas, Nevada USA 89147

Staking and posting: July 21, 2009

Signed in Las Vegas on this 22nd day of July, 2009

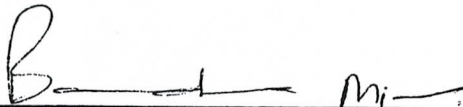

Bandna Misra, Trustee



Neha Gupta, President

RECEIVED
BLM AZ STATE OFFICE
2009 OCT - 1 A 8: 10
PHOENIX, ARIZONA

AMC 397905



B: 7542 P: 382

OFFICIAL RECORDS OF MOHAVE COUNTY CAROL MEIER, COUNTY RECORDER



07/22/2009 03:29 PM Fee: \$14.00 DOC TYPE: MINE PAID BY: B MISRA & N G H E

LOCATION NOTICE FOR LODE MINING CLAIM

NOTICE IS HEREBY GIVEN that the JAS-6 lode mining claim has been located

by B. MISRA & N. G. H. F. whose current mailing address is 3937 Tropical Vine St Las Vegas, Nevada 89147.

RECEIVED BLM AZ STATE OFFICE 2009 OCT -1 A 8:10 PHOENIX, ARIZONA

BLM Date Stamp

The general course of this claim is west to east and it is situated in Mohave County, Arizona. This claim is 1320 feet in length and 300 feet in width. This claim runs from the location monument on which this location notice is posted (in center) approximately 300 feet in a W direction to the west end line and 300 feet in a E direction to the east end line. This claim is marked by six monuments, one at each corner and one at the center of each end line of the claim.

The location monument on which this notice is posted is situated within Section 8, Township 15 N, Range 13 W, Gila Salt River Base and Meridian, Arizona and this claim encompasses portions of the following quarter section (s), section (s), Township (s) and Range (s) NW 1/4; S 8; T 15N; R 13W; Meridian 14

Gila Salt River Base and Meridian, Arizona.

The locality of this claim with reference to some natural object or permanent monument and additional information (if any) concerning its locality are as follows: 1.5" x 1.5" Wooden Square Posts; Four feet in length; Set one foot in ground. A 20 acres Lode Claim

DATED AND POSTED on the ground this 21 day of July, 2009.

LOCATOR (s) B. Misra, Trustee N.M. Trust N. Gupta, President NGH Foundation

Form MCF100 Revised July 2005

AMC 397906

MINING CLAIM MAP

Lode () Placer ()

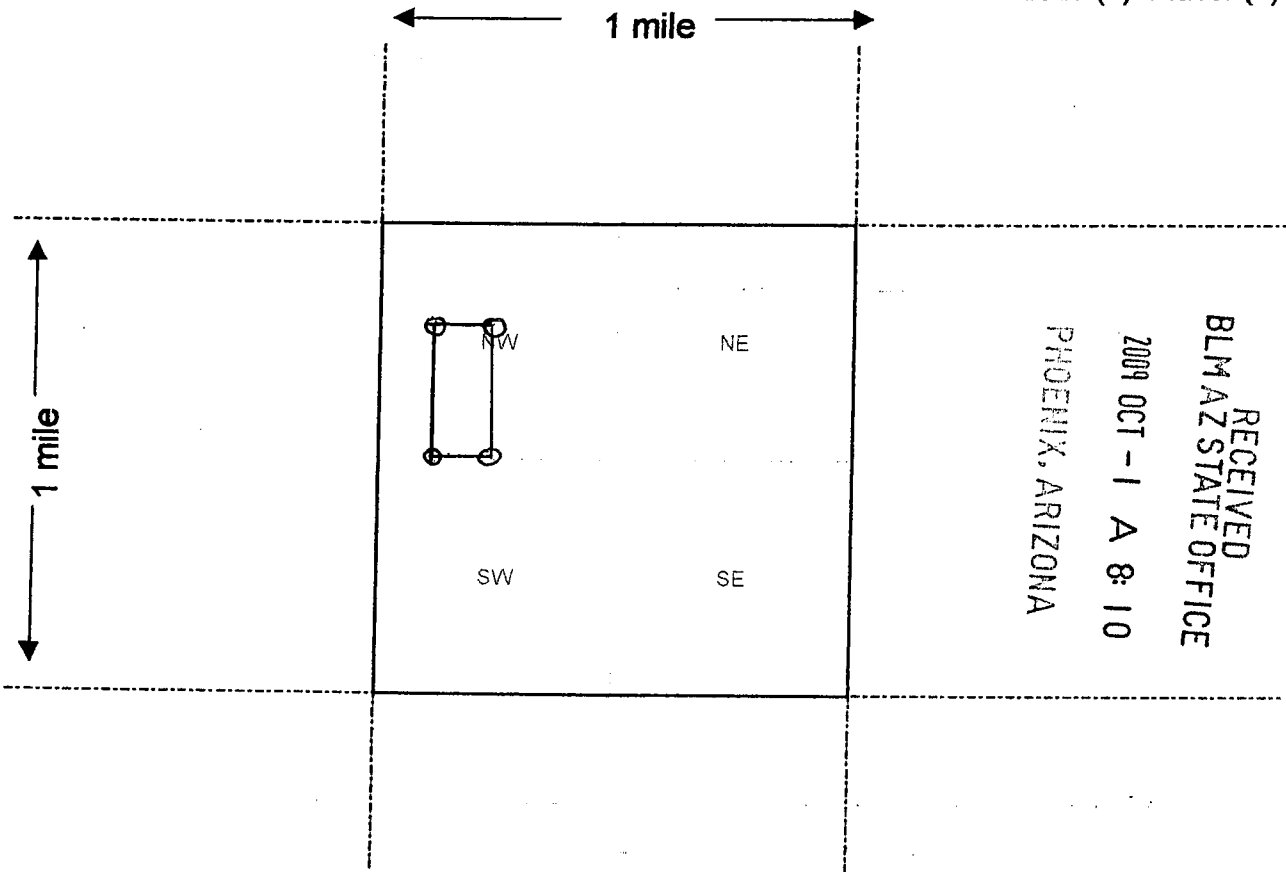

RECEIVED
 BLM AZ STATE OFFICE
 2009 OCT - 1 A 8: 10
 PHOENIX, ARIZONA

Scale : 1" = 2000 feet



1. The above map depicts the JAS-6 mining claim, which is located in Section (s) 8, Township 15 N, Range 13 W, Gila and Salt River Base and Meridian, Mohave County, Arizona.

2. The type of corner and location monuments used are as follows: 1.5" x 1.5" Wooden Square Posts; Four feet long; Set one foot in ground.

3. The bearings and distances in degrees and feet between claim corners are as depicted on the map.

Form MCF100a
 Revised July 2005

This form is available from the Arizona Department of Mines & Mineral Resources and may be reproduced.

AMC 397906

DEED OF OWNERSHIP

384

Date: July 22, 2009

County of Mohave
State of Nevada

Location: 160 acres. Northwest Quarter, Section 8, Township 15 North, Range 13 West, Meridian 14. Near Wikieup, Arizona.

Owner of Record:

(1) Bandna Misra, Trustee of the Nevada Mining Trust dated August 1, 2006 as fifty percent (50%) Owner.

and

(2) Neha Gupta Humanitarian Foundation, a Nevada Corporation as fifty percent (50%) Owner.

All located at 3937 Tropical Vine St., Las Vegas, Nevada USA 89147

Staking and posting: July 21, 2009

Signed in Las Vegas on this 22nd day of July, 2009

RECEIVED
BLM AZ STATE OFFICE
2009 OCT -1 A 8:10
PHOENIX, ARIZONA

ANC 397906

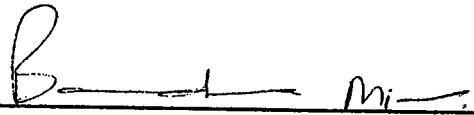

Bandna Misra, Trustee

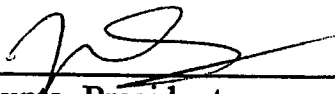

Neha Gupta, President

3



B: 7542 P: 385

OFFICIAL RECORDS OF MOHAVE COUNTY CAROL MEIER, COUNTY RECORDER



07/22/2009 03:29 PM Fee: \$14.00

DOC TYPE: MINE PAID BY: B MISRA & N G H E

RECEIVED BLM AZ STATE OFFICE 2009 OCT - 1 A 8: 10 PHOENIX, ARIZONA

LOCATION NOTICE FOR LODE MINING CLAIM

NOTICE IS HEREBY GIVEN that the JAS-7

- lode mining claim has been located

by B-MISRA & N-G-H-E whose current mailing address is 3937 Tropical Vine St Las Vegas, Nevada 89147

BLM Date Stamp

The general course of this claim is west to east and it is situated in Mohave County, Arizona. This claim is 1320 feet in length and 300 feet in width. This claim runs from the location monument on which this location notice is posted (in center) approximately 300 feet in a W direction to the west end line and 300 feet in a E direction to the east end line. This claim is marked by six monuments, one at each corner and one at the center of each end line of the claim.

The location monument on which this notice is posted is situated within Section 8, Township 15 N, Range 13 W, Gila Salt River Base and Meridian, Arizona and this claim encompasses portions of the following quarter section (s), section (s), Township (s) and Range (s) NW 1/4; S 8; T 15N; R 13W; Meridian 14

Gila Salt River Base and Meridian, Arizona.

The locality of this claim with reference to some natural object or permanent monument and additional information (if any) concerning its locality are as follows: 1.5" x 1.5" Wooden Square Posts; Four feet in length; Set one foot in ground. A 20 acres Lode Claim

DATED AND POSTED on the ground this 21 day of July, 2009.

LOCATOR (s) B-Misra, Trustee N M Trust N-Gupta, President NGH Foundation

Form MCF100 Revised July 2005

AMC 397907

306

MINING CLAIM MAP

Lode () Placer ()

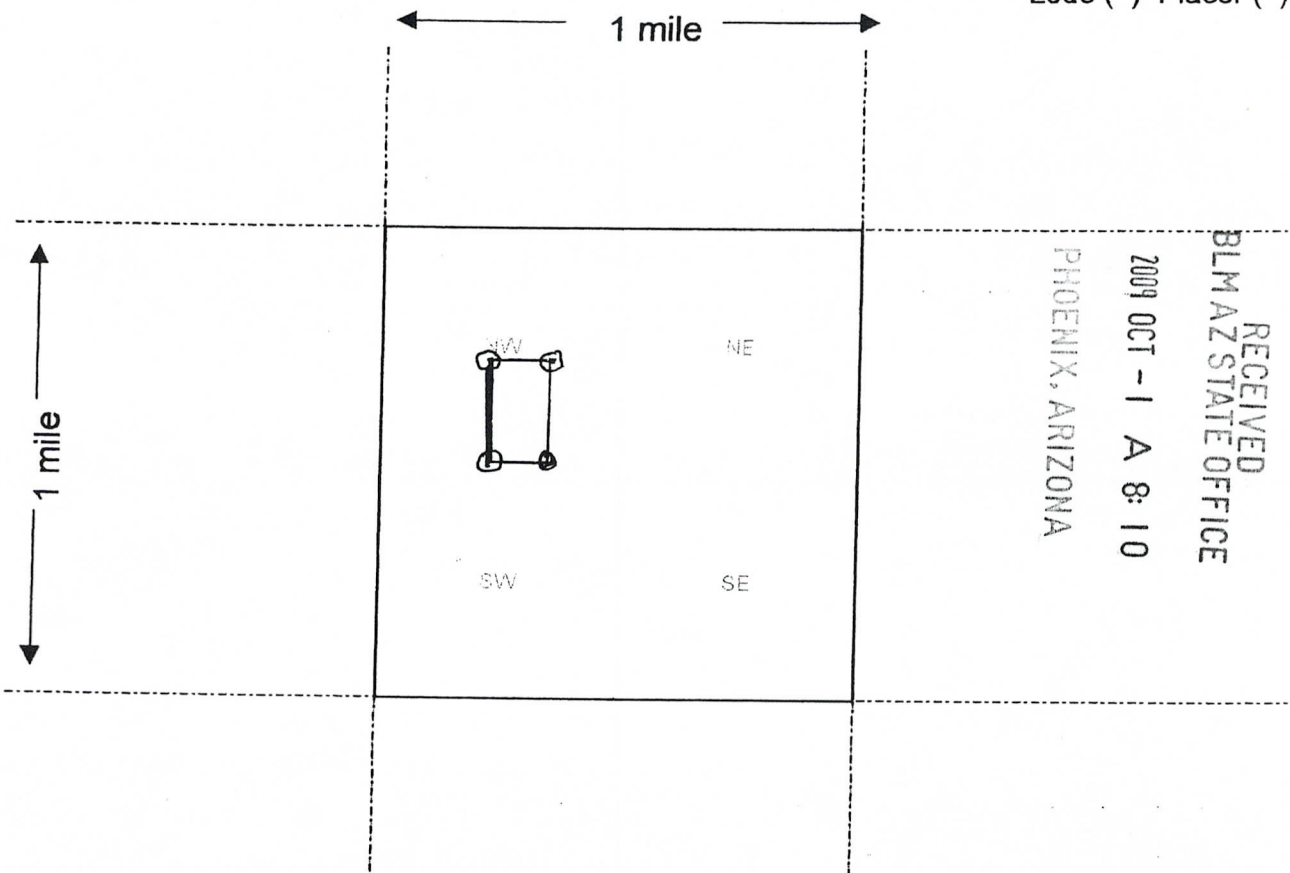

Scale : 1" = 2000 feet



1. The above map depicts the JAS-7 mining claim, which is located in Section (s) 8, Township 15 N, Range 13 W, Gila and Salt River Base and Meridian, Mohave County, Arizona.

2. The type of corner and location monuments used are as follows: 1.5" x 1.5" Wooden Square Posts; Four foot long; set one foot in ground

3. The bearings and distances in degrees and feet between claim corners are as depicted on the map.

Form MCF100a
Revised July 2005

387

DEED OF OWNERSHIP

Date: July 22, 2009

County of Mohave
State of Nevada

Location: 160 acres. Northwest Quarter, Section 8, Township 15 North, Range 13 West, Meridian 14. Near Wikieup, Arizona.

Owner of Record:

(1) Bandna Misra, Trustee of the Nevada Mining Trust dated August 1, 2006 as fifty percent (50%) Owner.

and

(2) Neha Gupta Humanitarian Foundation, a Nevada Corporation as fifty percent (50%) Owner.

All located at 3937 Tropical Vine St., Las Vegas, Nevada USA 89147

Staking and posting: July 21, 2009

Signed in Las Vegas on this 22nd day of July, 2009

RECEIVED
BLM AZ STATE OFFICE
2009 OCT - 1 A 8: 10
PHOENIX, ARIZONA

AMC 397907



Bandna Misra, Trustee



Neha Gupta, President

3



B: 7542 P: 388

OFFICIAL RECORDS OF MOHAVE COUNTY CAROL MEIER, COUNTY RECORDER



07/22/2009 03:29 PM Fee: \$14.00

DOC TYPE: MINE PAID BY: B MISRA & N G H F

RECEIVED BLM AZ STATE OFFICE 2009 OCT - 1 A 8: 10 PHOENIX, ARIZONA

LOCATION NOTICE FOR LODE MINING CLAIM

NOTICE IS HEREBY GIVEN that the JAS-8

- lode mining claim has been located

by B. MISRA & N.G.H.F. whose current mailing address is 3937 Tropical Vine St Las Vegas, Nevada 89147.

BLM Date Stamp

The general course of this claim is west to east and it is situated in Mohave County, Arizona. This claim is 1320 feet in length and 300 feet in width. This claim runs from the location monument on which this location notice is posted (in center) approximately 300 feet in a W direction to the west end line and 300 feet in a E direction to the east end line. This claim is marked by six monuments, one at each corner and one at the center of each end line of the claim.

The location monument on which this notice is posted is situated within Section 8, Township 15 N, Range 13 W, Gila Salt River Base and Meridian, Arizona and this claim encompasses portions of the following quarter section (s), section (s), Township (s) and Range (s) NW 1/4; S 8; T 15N; R 13W; Meridian 14

Gila Salt River Base and Meridian, Arizona.

The locality of this claim with reference to some natural object or permanent monument and additional information (if any) concerning its locality are as follows: 1.5" x 1.5" Wooden Square Posts; Four feet in length; Set one foot in ground. A 20 acres Lode Claim

DATED AND POSTED on the ground this 21 day of July, 2009.

LOCATOR (s) B. Misra, Trustee NM Trust N. Gupta, President NGH Foundation

Form MCF100 Revised July 2005

AMC 397908

389

MINING CLAIM MAP

Lode () Placer ()

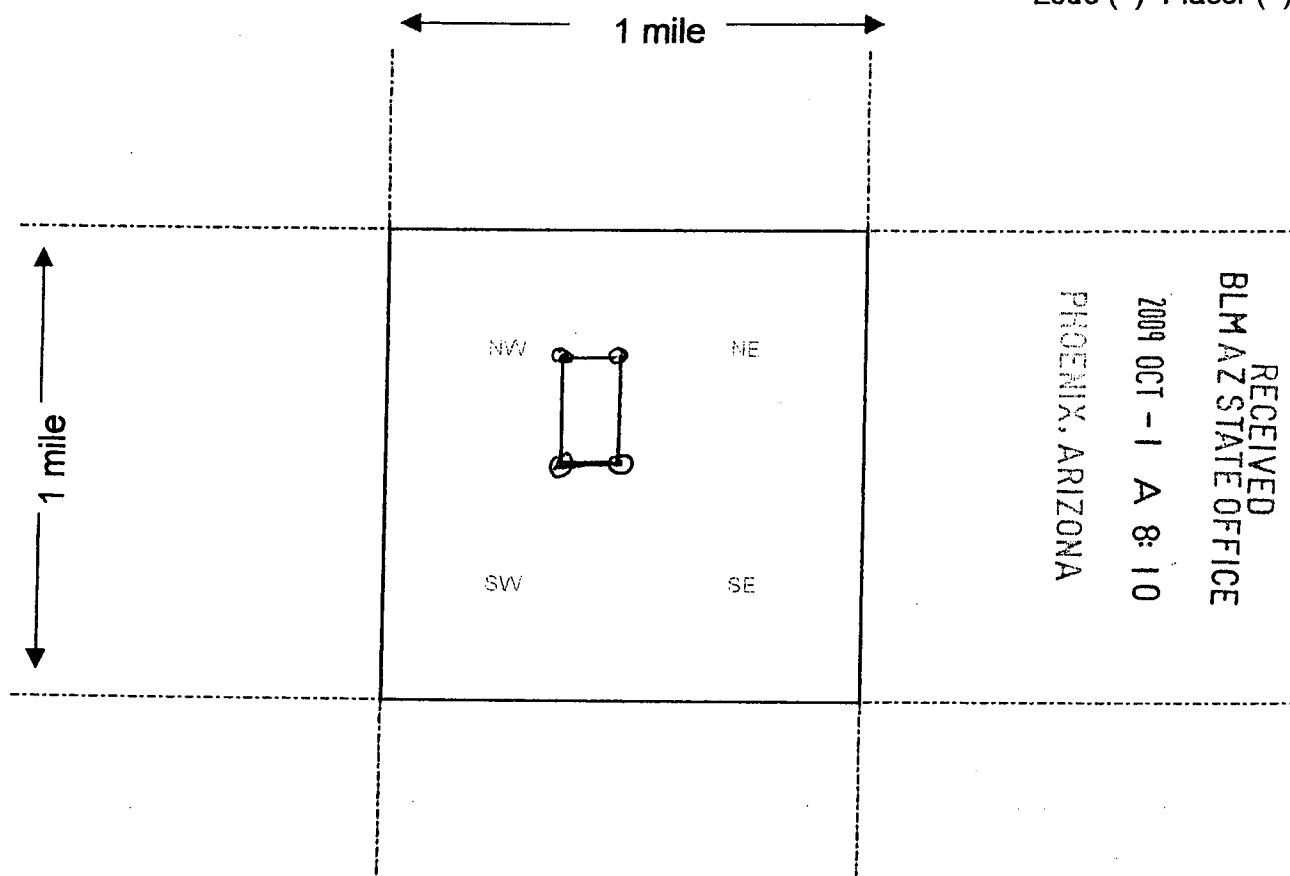

RECEIVED
BLM AZ STATE OFFICE
2009 OCT - 1 A 8:10
PHOENIX, ARIZONA

AMC 397908

Scale : 1" = 2000 feet



1. The above map depicts the JAS-8 mining claim, which is located in Section (s) 8, Township 15 N, Range 13 W, Gila and Salt River Base and Meridian, Mohave County, Arizona.

2. The type of corner and location monuments used are as follows: 1.5" x 1.5" Wooden Square Posts; four foot long; set one foot in ground

3. The bearings and distances in degrees and feet between claim corners are as depicted on the map.

Form MCF100a
Revised July 2005

DEED OF OWNERSHIP

390

ANC 397908

Date: July 22, 2009

County of Mohave
State of Nevada

Location: 160 acres. Northwest Quarter, Section 8, Township 15 North, Range 13 West, Meridian 14. Near Wikieup, Arizona.

Owner of Record:

(1) Bandna Misra, Trustee of the Nevada Mining Trust dated August 1, 2006 as fifty percent (50%) Owner.

and

(2) Neha Gupta Humanitarian Foundation, a Nevada Corporation as fifty percent (50%) Owner.

All located at 3937 Tropical Vine St., Las Vegas, Nevada USA 89147

Staking and posting: July 21, 2009

Signed in Las Vegas on this 22nd day of July, 2009

RECEIVED
BLM AZ STATE OFFICE
2009 OCT - 1 A 8: 10
PHOENIX, ARIZONA

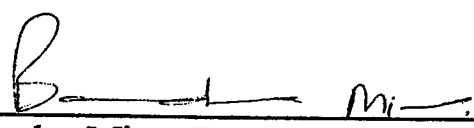

Bandna Misra, Trustee



Neha Gupta, President

Official Receipt
Mohave County Recorder's Office

Carol Meier, Recorder
 700 W Beale Street
 P.O. Box 70
 Kingman, AZ 86402
 (928) 753-0701

Receipt: 432439

Product	Name	Quantity	Unit Price	Extended
MINE	Notice of Mining Claim Location	1@	\$14.00	\$14.00
Document # 2009044638, Book/Page: B: 7542 P: 367, # Pages 3, Paid By: B MISRA & N G H E				
MINE	Notice of Mining Claim Location	1@	\$14.00	\$14.00
Document # 2009044639, Book/Page: B: 7542 P: 370, # Pages 3, Paid By: B MISRA & N G H E				
MINE	Notice of Mining Claim Location	1@	\$14.00	\$14.00
Document # 2009044640, Book/Page: B: 7542 P: 373, # Pages 3, Paid By: B MISRA & N G H E				
MINE	Notice of Mining Claim Location	1@	\$14.00	\$14.00
Document # 2009044641, Book/Page: B: 7542 P: 376, # Pages 3, Paid By: B MISRA & N G H E				
MINE	Notice of Mining Claim Location	1@	\$14.00	\$14.00
Document # 2009044642, Book/Page: B: 7542 P: 379, # Pages 3, Paid By: B MISRA & N G H E				
MINE	Notice of Mining Claim Location	1@	\$14.00	\$14.00
Document # 2009044643, Book/Page: B: 7542 P: 382, # Pages 3, Paid By: B MISRA & N G H E				
MINE	Notice of Mining Claim Location	1@	\$14.00	\$14.00
Document # 2009044644, Book/Page: B: 7542 P: 385, # Pages 3, Paid By: B MISRA & N G H E				
MINE	Notice of Mining Claim Location	1@	\$14.00	\$14.00
Document # 2009044645, Book/Page: B: 7542 P: 388, # Pages 3, Paid By: B MISRA & N G H E				
COPY	Copy	1@	\$24.00	\$24.00
Copies 24, Certified Copies 0, Conformed Copies 0, Paid By B MISRA & N G H F				
Total				\$136.00
Tender (Cash)				\$140.00
Change (Cash)				(\$4.00)

RECEIVED
 BLM AZ STATE OFFICE
 2009 OCT - 1 A 8:04
 PHOENIX, ARIZONA

ANC 397901

Sept. 25, 2009

B. Misra
3937 Tropical Vine St
Las Vegas, NV 89147

B.L.M. - Mining Dept.
1 North Central Av
Suite 800
Phoenix, AZ 85004

AMC 397901

Dear Sirs,

Please record these eight Lode Claims now. They have already been filed with Mohave County.

Filing fees totaling $(\$189)(8) = \$1,512$ are attached herewith.

Thank You.

PHOENIX, ARIZONA

2009 OCT - 1 A 8: 04

RECEIVED
BLM AZ STATE OFFICE

DEPARTMENT OF INTERIOR
BUREAU OF LAND MANAGEMENT

Input Parameters for Geographic Report with Land

System Id = CR

Admin State = AZ

Geo State = AZ

Casetype Begins With

Case Disp Txt = AUTHORIZED, CANCELLED, EXPIRED, PENDING, REJECTED, RELINQUISHED, WITHDRAWN

Mer Twp Rng =

Section =

Mtrs = 14 0150N 0130W 008

Commodity =

Commodity Txt =

Pending Org =

Pend Org Decode =

Total Rows Returned: 0

